

# K-STECKNIPPEL RED

push-in plugs, unequal

**HANSA FLEX**

## Properties

<b>Working pressure</b>	Max. 15 bar, coarse vacuum
<b>Application</b>	Air, vacuum
<b>Recommended hoses</b>	PU or PA (nylon)
<b>Media</b>	Compressed air and all gases or liquids that are compatible with the materials
<b>Temp. range</b>	-20 °C to +80 °C
<b>Sealing surface</b>	Parallel version: O-ring in housing, Conical version: thread coating
<b>Material</b>	Plastic, Nickel plated brass
<b>Contact pressure ring</b>	Plastic

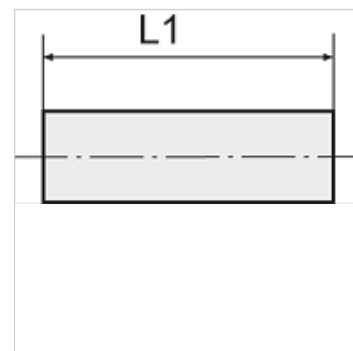

## Note

Further information on request

## Description

Push-in fittings series manufactured in plastic and nickel-plated brass. All parts are suitable for use with hoses, tubes or pipes made of plastic and copper.

## Item

Identification	for external hose Ø	L1 (mm)
K- 07 40 42 83	6 mm / 4 mm	37,5
K- 07 40 42 84	8 mm / 4 mm	40,5
K- 07 40 42 85	8 mm / 6 mm	42,5
K- 07 40 42 86	10 mm / 6 mm	44,5
K- 07 40 42 87	10 mm / 8 mm	47,0
K- 07 40 42 88	12 mm / 8 mm	49,5
K- 07 40 42 89	12 mm / 10 mm	51,0