

# K-SCHOTTVERB POLYPROPYLEN

Bulkhead couplings - polypropylene

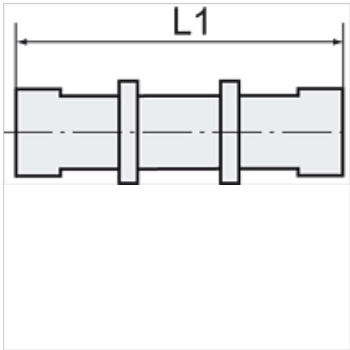

| Properties            |   |
|-----------------------|---|
| Operating pressure    | Dependent on operating temperature; Max. 10 bar (at 20 °C); Max. 2.5 bar (at 90 °C) |
| Material              | Polypropylene (PP)  |
| Operating temperature | Max. 90 °C  |

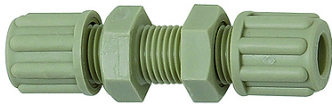

## Note

Further information on request

## Description

Chemically resistant to almost all inorganic acids and bases, even in high concentrations and at temperatures greater than 90 °C.

| Item           |              |            |            |       |
|----------------|--------------|------------|------------|-------|
| Identification | for hose     | Thread     | L1<br>(mm) | AF    |
| K- 07 40 41 71 | 4 mm / 6 mm  | M 10 x 1   | 53,0       | 14 mm |
| K- 07 40 41 72 | 6 mm / 8 mm  | M 14 x 1.5 | 64,0       | 19 mm |
| K- 07 40 41 73 | 8 mm / 10 mm | M 16 x 1.5 | 73,0       | 22 mm |
| K- 07 40 41 74 | 9 mm / 12 mm | M 18 x 1.5 | 84,0       | 24 mm |