

K-SCHOTT-STECK MINI

Bulkhead connectors, mini

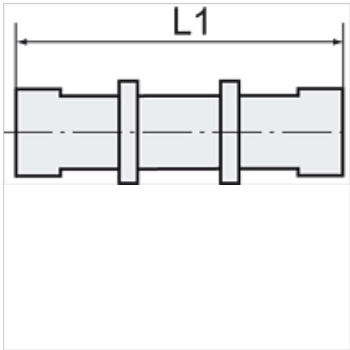

Properties	
Working pressure	Max. 10 bar, vacuum
Application	Air, vacuum
Recommended hoses	PU or PA (nylon)
Media	Compressed air
Standard	M thread acc. to DIN 13-1, with O-Ring G thread acc. to DIN EN ISO 228-1, with O-Ring R thread acc. to ISO 7-1, thread coating
Temp. range	0 °C to +60 °C
Material	Plastic, Nickel plated brass
Contact pressure ring	Plastic



Note

Further information on request

Description

Push-in fittings series manufactured in plastic and nickel-plated brass, space-saving miniature design.

Item				
Identification	Thread	for external hose Ø	L1 (mm)	AF
K- 07 40 50 12	M 8 x 0.75	3 mm	20,3	10 mm
K- 07 40 50 10	M 10 x 1.0	4 mm	24,0	12 mm
K- 07 40 50 11	M 12 x 1.0	6 mm	23,8	14 mm