

K-L-STECKVER DREH AG-K BESCH

Male elbows, swivel type, conical male thread, coated

HANSA FLEX

Properties

| | |
|------------------------------|--|
| Working pressure | Max. 15 bar, coarse vacuum |
| Application | Air, vacuum |
| Recommended hoses | PU or PA (nylon) |
| Media | Compressed air and all gases or liquids that are compatible with the materials |
| Temp. range | -20 °C to +80 °C |
| Sealing surface | Conical version: thread coating |
| Material | Plastic, Nickel plated brass |
| Contact pressure ring | Plastic |

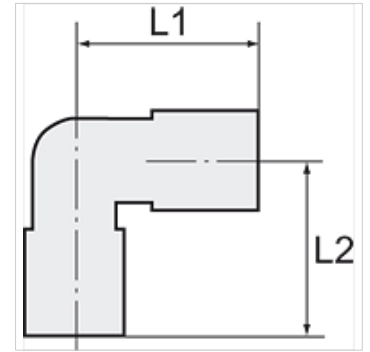
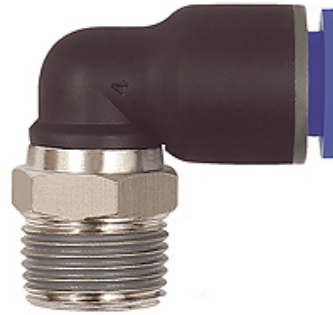

Note

Further information on request

Description

Push-in fittings series manufactured in plastic and nickel-plated brass. All parts are suitable for use with hoses, tubes or pipes made of plastic and copper.

Item

| Identification | Thread | for external hose Ø | L1 (mm) | L2 (mm) | AF |
|----------------|--------|---------------------|------------|------------|-------|
| K- 07 40 01 68 | R 1/8 | 4 mm | 18,8 | 18,5 | 10 mm |
| K- 07 40 01 69 | R 1/8 | 6 mm | 20,0 | 19,5 | 10 mm |
| K- 07 40 01 70 | R 1/8 | 8 mm | 22,5 | 22,9 | 10 mm |
| K- 07 40 01 65 | R 1/4 | 4 mm | 18,8 | 20,0 | 14 mm |
| K- 07 40 01 66 | R 1/4 | 6 mm | 20,0 | 21,0 | 14 mm |
| K- 07 40 01 67 | R 1/4 | 8 mm | 22,5 | 21,5 | 14 mm |
| K- 07 40 01 63 | R 1/4 | 10 mm | 26,9 | 26,3 | 17 mm |
| K- 07 40 01 64 | R 1/4 | 12 mm | 28,5 | 27,8 | 17 mm |
| K- 07 40 01 74 | R 3/8 | 6 mm | 20,0 | 22,5 | 17 mm |
| K- 07 40 01 75 | R 3/8 | 8 mm | 22,5 | 23,0 | 17 mm |
| K- 07 40 01 71 | R 3/8 | 10 mm | 26,9 | 24,8 | 17 mm |
| K- 07 40 01 72 | R 3/8 | 12 mm | 28,5 | 26,3 | 17 mm |
| K- 07 40 01 73 | R 3/8 | 16 mm | 33,5 | 33,7 | 20 mm |
| K- 07 40 01 61 | R 1/2 | 6 mm | 20,0 | 25,5 | 21 mm |
| K- 07 40 01 62 | R 1/2 | 8 mm | 22,5 | 26,0 | 21 mm |
| K- 07 40 01 58 | R 1/2 | 10 mm | 26,9 | 27,8 | 21 mm |
| K- 07 40 01 59 | R 1/2 | 12 mm | 28,5 | 29,3 | 21 mm |
| K- 07 40 01 60 | R 1/2 | 16 mm | 33,5 | 36,7 | 21 mm |