

# K-Y-STECK VB RED 10 BAR

Y unions, unequal (pressure max. 10 bar)

**HANSA FLEX**

## Properties

<b>Working pressure</b>	Max. 10 bar
<b>Application</b>	Air, vacuum
<b>Recommended hoses</b>	PU or PA (nylon)
<b>Media</b>	Compressed air and all gases or liquids that are compatible with the materials
<b>Temp. range</b>	-20 °C to +80 °C
<b>Material</b>	Plastic, Nickel plated brass
<b>Contact pressure ring</b>	Plastic

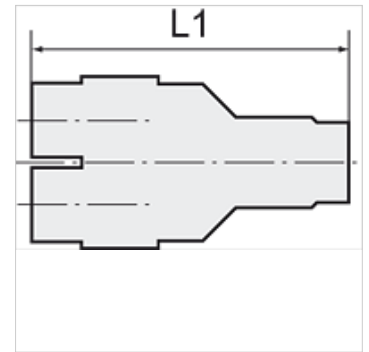
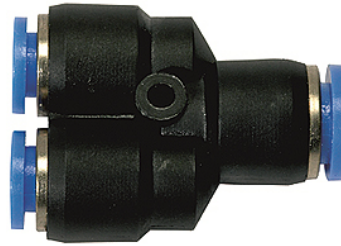

## Note

Further information on request

## Description

Push-in fittings series manufactured in plastic and nickel-plated brass. All parts are suitable for use with hoses, tubes or pipes made of plastic and copper.

## Item

Identification	for external hose Ø	L1 (mm)
K- 07 40 03 81	1 x 6 mm / 2 x 4 mm	36,5
K- 07 40 42 07	1 x 8 mm / 2 x 4 mm	42,0
K- 07 40 03 82	1 x 8 mm / 2 x 6 mm	39,8
K- 07 40 42 08	1 x 10 mm / 2 x 6 mm	43,8
K- 07 40 03 83	1 x 10 mm / 2 x 8 mm	48,9
K- 07 40 42 09	1 x 12 mm / 2 x 8 mm	52,0
K- 07 40 03 84	1 x 12 mm / 2 x 10 mm	52,6