

K-T-STECK VERS ISK DREH AG OR1

Male branch tees with inner hex, swivel type, parallel male thread with O-ring

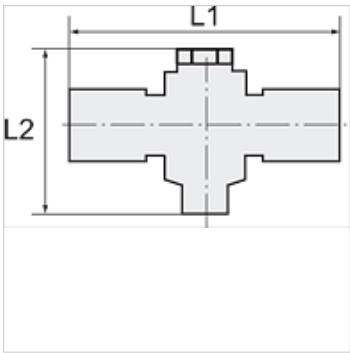

Properties	
Working pressure	Max. 15 bar, coarse vacuum
Application	Air, vacuum
Recommended hoses	PU or PA (nylon)
Media	Compressed air and all gases or liquids that are compatible with the materials
Temp. range	-20 °C to +80 °C
Sealing surface	Parallel version: O-ring in housing
Material	Plastic, Nickel plated brass
Contact pressure ring	Plastic



Note

Further information on request

Description

Push-in fittings series manufactured in plastic and nickel-plated brass. All parts are suitable for use with hoses, tubes or pipes made of plastic and copper.

Item						
Identification	Thread	for external hose Ø	hexagon socket (mm)	L1 (mm)	L2 (mm)	AF
K- 07 40 06 21	G 1/8	4 mm	4,0	45,0	28,5	14 mm
K- 07 40 06 22	G 1/8	6 mm	4,0	42,6	28,5	14 mm
K- 07 40 06 23	G 1/8	8 mm	4,0	48,5	28,5	14 mm
K- 07 40 06 19	G 1/4	6 mm	6,0	46,7	37,5	17 mm
K- 07 40 06 20	G 1/4	8 mm	6,0	52,5	37,5	17 mm
K- 07 40 06 17	G 1/4	10 mm	6,0	59,6	37,5	17 mm
K- 07 40 06 18	G 1/4	12 mm	6,0	60,7	37,5	17 mm
K- 07 40 06 26	G 3/8	8 mm	8,0	56,3	39,2	20 mm
K- 07 40 06 24	G 3/8	10 mm	8,0	63,5	39,2	20 mm
K- 07 40 06 25	G 3/8	12 mm	8,0	64,9	39,2	20 mm