

# K-K STUECK IG AG

Crosses, 3 x female, 1 x male

**HANSA FLEX**

## Properties

Operating pressure	60 bar
Operating temperature	Max. 150 °C
Female thread	Parallel to DIN EN ISO 228-1
Material	Nickel-plated brass
Male thread	conical acc. DIN 2999

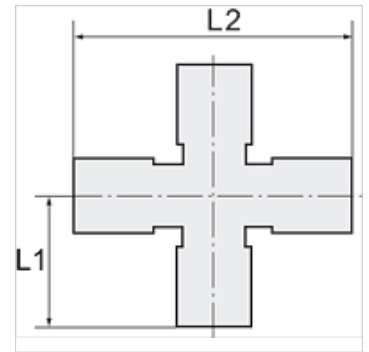

## Note

Further information on request

## Item

Identification	Thread	L1 (mm)	L2 (mm)	AF
K- 07 40 49 11	G/R 1/8	18,5	42,0	10 mm
K- 07 40 49 12	G/R 1/4	23,5	51,0	13 mm
K- 07 40 49 13	G/R 3/8	26,0	56,0	17 mm
K- 07 40 49 14	G/R 1/2	31,0	67,0	21 mm