

K-G-STECK VB 20-63 AG INFI

Straight push-in connector Ø 20 mm – Ø 63 mm with external thread

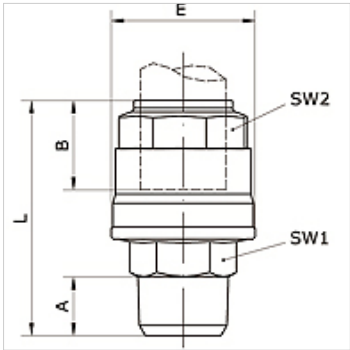

Properties	
Media	Compressed air, vacuum, inert gases
Operating pressure	-0,99 bar - 15 bar
Temp. range	-20 °C to +80 °C
Seal	NBR
Housing	Aluminium
Clamp ring	Stainless steel 1.4301
Nut	Aluminium
O-ring	NBR
Locking ring	Technopolymer



Item								
Identification	External pipe Ø	Connection	A (mm)	B (mm)	E (mm)	L (mm)	AF1 (mm)	AF2 (mm)
K- 07 40 54 95	63 mm	R 2	24,0	57,5	94,0	109,5	65	75
K- 07 40 54 96	63 mm	R 2 1/2	24,0	57,5	94,0	106,5	75	75