

K-RD HANSA PRO

Non-return valve, HANSA PRO

Properties

Media temperature	-10 °C to +50 °C
Ambient temperature	-10 °C to +50 °C
Media	Compressed air
Design	poppet valve, spring-loaded
Mounting type	Line mounting, mounting kit or wall mounting
Installation position	Any
Nominal flow-rate G1/2	5.000 l/min (P1 = 6 bar/Delta P = 1 bar)
Nominal flow-rate G 3/8	5.000 l/min (P1 = 6 bar/Delta P = 1 bar)
PE max 11	16 bar
Housing	PA66

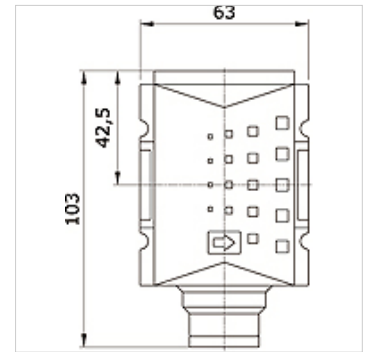

Item

Identification	Connection	Size
K- 07 25 22 62	G 3/8 i	2
K- 07 25 22 63	G 1/2 i	2