

HK SAH

Hollow piston cylinder aluminium 700 bar

Properties

Design	Hardened valvehead hard chrome-plated pistons spring return
Operating pressure	max. 700 bar
Material	Aluminium
Surface	anodised
Scope of supply	with female quick coupling 3/8"-18 NPT

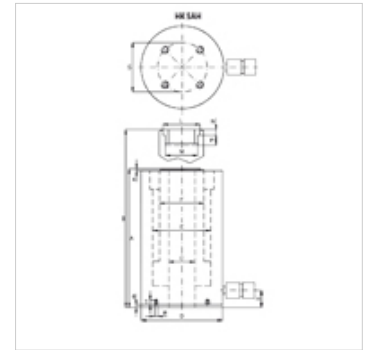

Note

Attention: Please observe separate safety precautions for working with 700 bar equipment (see technical information)!

Description

- Hollow piston cylinders are employed for pushing and pulling actuation.
- Very low weight (-40% of a comparable steel cylinder)
- Thread on cylinder housing ensures simple mounting
- Plunger wiper seals to prevent soiling
- Replaceable supporting head
- Not suitable for long-term applications with high repetition frequencies.

Item

Identification	Stroke		Area		A	B	C	D	E	F	H	K	L	M	N	R	S	T	Volume	Weight
	(kN)	(t)	(mm)	(cm ²)	(mm)	(mm)	(mm)	(mm)	(mm)	(mm)	(mm)	(mm)	(mm)	(mm)	(mm)	(mm)	(mm)	(mm)	(cc)	(kg)
HK SAH 03015	301,8	30	150	44,0	352	502	33,0	130	90	68	32	4,0	55	1.11/13"-16	9	M6	110,0	19	660	11,5
HK SAH 06010	578,0	60	100	84,0	298	398	56,0	175	125	95	37	4,0	80	2.3/4"-16	12	M6	155,0	19	842	19,5