

## Características

|                       |                                                  |
|-----------------------|--------------------------------------------------|
| Conexión 1            | Rosca interior BSP cilíndricas                   |
| Forma de obturación 1 | Forma A                                          |
| Conexión 2            | Rosca exterior métrica, cilíndrica               |
| Forma de obturación 2 | Cono interior de 24°                             |
| Construcción          | Racor de rosca hembra                            |
| Forma constructiva    | recto                                            |
| Norma                 | DIN 2353<br>ISO 8434-1                           |
| Volumen de suministro | Tubuladura con tuerca de racor y anillo cortante |
| Material              | Acero fino                                       |

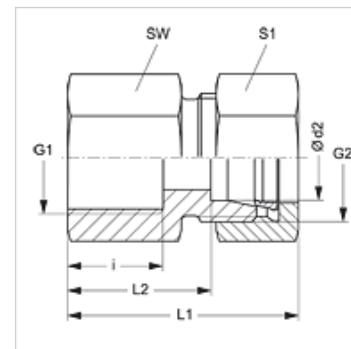

## Artículo

| Denominación        | Serie | Presión de servicio en bar | Ø d2 (mm) | G1           | G2         | i (mm) | L1 (mm) | L2 (mm) | SW (mm) | S1 |
|---------------------|-------|----------------------------|-----------|--------------|------------|--------|---------|---------|---------|----|
| GAR NW 04 HL VA     | L     | PN 315                     | 6         | G 1/8" -28   | M 12 x 1,5 | 12,0   | 34,0    | 19,0    | 14      | 14 |
| GAR NW 04 HL 1/4 VA | L     | PN 315                     | 6         | G 1/4" -19   | M 12 x 1,5 | 12,0   | 34,0    | 19,0    | 14      | 14 |
| GAR NW 04 HL 3/8 VA | L     | PN 315                     | 6         | G 3/8" -19   | M 12 x 1,5 | 12,0   | 36,0    | 21,0    | 22      | 14 |
| GAR NW 04 HL 1/2 VA | L     | PN 315                     | 6         | G 1/2" -14   | M 12 x 1,5 | 20,0   | 46,0    | 31,0    | 27      | 14 |
| GAR NW 06 HL VA     | L     | PN 315                     | 8         | G 1/4" -19   | M 14 x 1,5 | 17,0   | 39,0    | 24,0    | 19      | 17 |
| GAR NW 06 HL 3/8 VA | L     | PN 315                     | 8         | G 3/8" -19   | M 14 x 1,5 | 17,0   | 36,0    | 21,0    | 22      | 17 |
| GAR NW 06 HL 1/2 VA | L     | PN 315                     | 8         | G 1/2" -14   | M 14 x 1,5 | 20,0   | 44,0    | 29,0    | 27      | 17 |
| GAR NW 08 HL VA     | L     | PN 315                     | 10        | G 1/4" -19   | M 16 x 1,5 | 17,0   | 40,0    | 25,0    | 19      | 19 |
| GAR NW 08 HL 3/8 VA | L     | PN 315                     | 10        | G 3/8" -19   | M 16 x 1,5 | 17,0   | 40,0    | 26,0    | 22      | 19 |
| GAR NW 08 HL 1/2 VA | L     | PN 315                     | 10        | G 1/2" -14   | M 16 x 1,5 | 20,0   | 45,0    | 30,0    | 27      | 19 |
| GAR NW 10 HL 1/4 VA | L     | PN 315                     | 12        | G 1/4" -19   | M 18 x 1,5 | 17,0   | 41,0    | 25,0    | 19      | 22 |
| GAR NW 10 HL VA     | L     | PN 315                     | 12        | G 3/8" -19   | M 18 x 1,5 | 17,0   | 41,0    | 26,0    | 22      | 22 |
| GAR NW 10 HL 1/2 VA | L     | PN 315                     | 12        | G 1/2" -14   | M 18 x 1,5 | 20,0   | 44,0    | 30,0    | 27      | 22 |
| GAR NW 13 HL 3/8 VA | L     | PN 315                     | 15        | G 3/8" -19   | M 22 x 1,5 | 17,0   | 46,0    | 27,0    | 24      | 27 |
| GAR NW 13 HL VA     | L     | PN 315                     | 15        | G 1/2" -14   | M 22 x 1,5 | 20,0   | 45,0    | 30,0    | 27      | 27 |
| GAR NW 16 HL 3/8 VA | L     | PN 315                     | 18        | G 3/8" -19   | M 26 x 1,5 | 17,5   | 47,0    | 26,5    | 27      | 32 |
| GAR NW 16 HL VA     | L     | PN 315                     | 18        | G 1/2" -14   | M 26 x 1,5 | 20,0   | 46,0    | 29,5    | 27      | 32 |
| GAR NW 20 HL 1/2 VA | L     | PN 160                     | 22        | G 1/2" -14   | M 30 x 2   | 20,0   | 55,0    | 33,5    | 32      | 36 |
| GAR NW 20 HL VA     | L     | PN 160                     | 22        | G 3/4" -14   | M 30 x 2   | 22,0   | 51,0    | 34,5    | 32      | 36 |
| GAR NW 25 HL VA     | L     | PN 160                     | 28        | G 1" -11     | M 36 x 2   | 24,5   | 53,5    | 37,0    | 41      | 41 |
| GAR NW 32 HL VA     | L     | PN 160                     | 35        | G 1.1/4" -11 | M 45 x 2   | 26,5   | 60,5    | 39,0    | 50      | 50 |
| GAR NW 40 HL VA     | L     | PN 160                     | 42        | G 1.1/2" -11 | M 52 x 2   | 28,5   | 63,5    | 40,5    | 55      | 60 |
| GAR NW 03 HS 1/8 VA | S     | PN 400                     | 6         | G 1/8" -28   | M 14 x 1,5 | 12,0   | 34,0    | 19,0    | 14      | 14 |
| GAR NW 03 HS VA     | S     | PN 400                     | 6         | G 1/4" -19   | M 14 x 1,5 | 17,0   | 41,0    | 26,0    | 19      | 17 |
| GAR NW 04 HS VA     | S     | PN 400                     | 8         | G 1/4" -19   | M 16 x 1,5 | 17,0   | 41,0    | 26,0    | 19      | 19 |
| GAR NW 06 HS VA     | S     | PN 400                     | 10        | G 3/8" -19   | M 18 x 1,5 | 17,0   | 42,0    | 26,5    | 24      | 22 |
| GAR NW 06 HS 1/2 VA | S     | PN 400                     | 10        | G 1/2" -14   | M 18 x 1,5 | 20,0   | 49,5    | 30,5    | 27      | 22 |
| GAR NW 08 HS 1/4 VA | S     | PN 400                     | 12        | G 1/4" -19   | M 20 x 1,5 | 17,0   | 46,0    | 27,5    | 22      | 24 |
| GAR NW 08 HS VA     | S     | PN 400                     | 12        | G 3/8" -19   | M 20 x 1,5 | 17,0   | 42,0    | 26,5    | 24      | 24 |
| GAR NW 08 HS 1/2 VA | S     | PN 400                     | 12        | G 1/2" -14   | M 20 x 1,5 | 20,0   | 50,0    | 30,5    | 27      | 24 |
| GAR NW 10 HS VA     | S     | PN 400                     | 14        | G 1/2" -14   | M 22 x 1,5 | 20,0   | 50,0    | 32,0    | 27      | 27 |
| GAR NW 13 HS VA     | S     | PN 400                     | 16        | G 1/2" -14   | M 24 x 1,5 | 20,0   | 50,0    | 31,5    | 27      | 30 |
| GAR NW 16 HS 3/8 VA | S     | PN 315                     | 20        | G 3/8" -19   | M 30 x 2   | 17,0   | 50,0    | 30,0    | 24      | 36 |
| GAR NW 16 HS 1/2 VA | S     | PN 315                     | 20        | G 1/2" -14   | M 30 x 2   | 20,0   | 57,0    | 32,5    | 32      | 36 |
| GAR NW 16 HS VA     | S     | PN 315                     | 20        | G 3/4" -14   | M 30 x 2   | 22,0   | 56,0    | 34,5    | 36      | 36 |
| GAR NW 20 HS VA     | S     | PN 315                     | 25        | G 1" -11     | M 36 x 2   | 24,5   | 61,5    | 37,5    | 41      | 46 |
| GAR NW 25 HS VA     | S     | PN 315                     | 30        | G 1.1/4" -11 | M 42 x 2   | 26,5   | 68,5    | 42,0    | 50      | 50 |
| GAR NW 32 HS VA     | S     | PN 250                     | 38        | G 1.1/2" -11 | M 52 x 2   | 28,5   | 74,5    | 43,5    | 60      | 60 |

Serie: LL = muy ligero L = ligero S = pesado - PN = presión nominal PB = presión de servicio máx. - Ø d2 = diámetro exterior del tubo

## Variantes de producto

|         |                                   |
|---------|-----------------------------------|
| GAR     | Racor de rosca hembra, Acero      |
| GAR MG  | Racor de rosca hembra, Latón      |
| XGAR VA | Racor de rosca hembra, Acero fino |