

# HK ROTEX AF

Acoplamiento Rotex para bombas de pistón axial y bombas de paletas

**HANSA FLEX**

## Características

|                    |  |
|--------------------|--|
| <b>Versión</b>     | combinable con portabombas HK PK                   |
| <b>Material</b>    | GG   |
| <b>Utilización</b> | For axial piston pump HK PVPC and vane pump HK PFE |

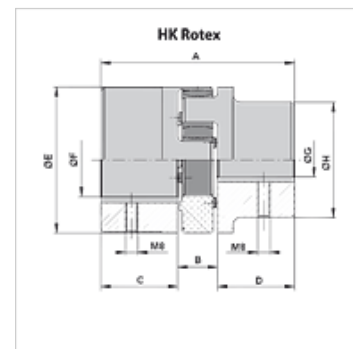

## Descripción

Torsión flexible, amortiguador de vibraciones, sin mantenimiento  
 Conectable axialmente, asegurado contra descarga disruptiva  
 Construcción compacta, momento de impulso

## Artículo

| Denominación          | A    | B    | C    | D    | Ø E  | Ø F  | Ø G   | Ø H  | Ancho de ranura lado de bomba | Motor     | Bomba    | Peso |
|-----------------------|------|------|------|------|------|------|-------|------|-------------------------------|-----------|----------|------|
|                       | (mm) | (mm) | (mm) | (mm) | (mm) | (mm) | (mm)  | (mm) | (mm)                          |           |          | (kg) |
| HK R 3842-22.22 G     | 114  | 24   | 45   | 45   | 80   | 42   | 22,22 | 66   | 4,75                          | BG160     | HKPFE41  | 2,5  |
| HK R 3842-22.22 F     | 114  | 24   | 45   | 45   | 80   | 42   | 22,22 | 66   | 6,38                          | BG160     | HKPVPC30 | 2,5  |
| HK R 3842-25.38 BS    | 114  | 24   | 45   | 45   | 80   | 42   | 25,38 | 66   | 6,37                          | BG160     | HKPVPC40 | 2,5  |
| HK R 4248-22.22 G     | 126  | 26   | 50   | 50   | 95   | 48   | 22,22 | 75   | 4,75                          | BG180     | HKPFE41  | 3,9  |
| HK R 4248-34.92 M     | 126  | 26   | 50   | 50   | 95   | 48   | 34,92 | 75   | 7,93                          | BG180     | HKPFE52  | 3,9  |
| HK R 4248-22.22 F     | 126  | 26   | 50   | 50   | 95   | 48   | 22,22 | 75   | 6,38                          | BG180     | HKPVPC30 | 3,9  |
| HK R 4248 75-25 38 BS | 151  | 26   | 75   | 50   | 95   | 48   | 25,38 | 75   | 6,37                          | BG160/180 | HKPVPC40 | 4,5  |
| HK R 4248-31.75 K     | 126  | 26   | 50   | 50   | 95   | 48   | 31,75 | 75   | 7,93                          | BG180     | HKPVPC50 | 3,9  |
| HK R 4255-34.92 M     | 126  | 26   | 50   | 50   | 95   | 55   | 34,92 | 75   | 7,93                          | BG200     | HKPFE52  | 3,9  |
| HK R 4255 75-25 38 BS | 151  | 26   | 75   | 50   | 95   | 55   | 25,38 | 75   | 6,37                          | BG200     | HKPVPC40 | 4,5  |
| HK R 4255-31.75 K     | 126  | 26   | 50   | 50   | 95   | 55   | 31,75 | 75   | 7,93                          | BG200     | HKPVPC50 | 3,9  |
| HK R 4860 80-31.75 K  | 164  | 28   | 80   | 56   | 105  | 60   | 31,75 | 85   | 7,93                          | BG225     | HKPVPC50 | 6,0  |