

K-MUFFEN ABSPERRVENTIL VA

Female thread globe valves

HANSA FLEX

Características

| | |
|---------------------|-------------------------------|
| Presión de servicio | max. 14 bar |
| Temper. de medios | max. +160 °C |
| Carcasa, pieza int. | Stainless Steel 1.4401/1.4408 |
| Obturac. | FKM (FPM) |
| Rueda manual | Aluminium |

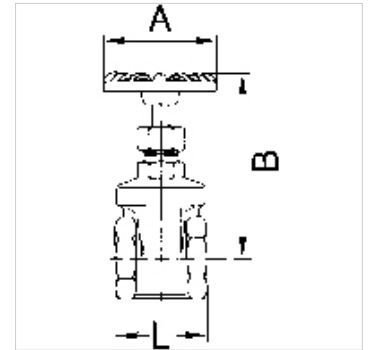
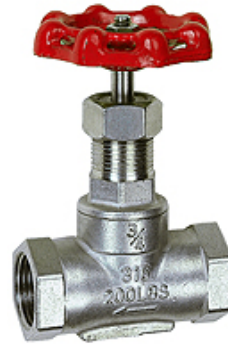

Nota

Otras especificaciones a petición.

Artículo

| Denominación | DN | Rosca | A (mm) | B cerrado | B abier | L (mm) |
|----------------|----|---------|-----------|-----------|---------|-----------|
| K- 07 30 22 16 | 10 | G 3/8 | 70,0 | 89 | 99 | 52,0 |
| K- 07 30 22 17 | 15 | G 1/2 | 70,0 | 89 | 99 | 52,0 |
| K- 07 30 22 18 | 20 | G 3/4 | 80,0 | 95 | 107 | 66,0 |
| K- 07 30 22 19 | 25 | G 1 | 80,0 | 102 | 118 | 76,0 |
| K- 07 30 22 20 | 32 | G 1 1/4 | 90,0 | 130 | 150 | 86,0 |
| K- 07 30 22 21 | 40 | G 1 1/2 | 90,0 | 132 | 142 | 94,0 |
| K- 07 30 22 22 | 50 | G 2 | 100,0 | 154 | 167 | 118,0 |