

K-DRS ELK GERAETESTECKER

Pressure switches, connection with plug connector, type A acc. to DIN 43650

HANSA FLEX

Características

Campo de aplicación	Pneumatic applications
Frecuencia de func.	200/min.
Tensión con.	max. 250 V AC / 28 V DC
Tipo de protecc.	IP 65 (DIN 43650), IP 67 (M 12 x 1)
Rango de temperatura	-10 °C to +80 °C
Tapa de ajuste	Aluminium, powder-coated
Carcasa	Special die-cast material
Membrana, junta	NBR

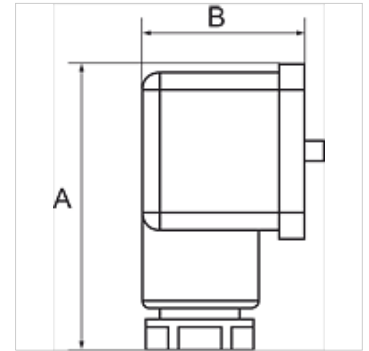

Nota

Otras especificaciones a petición.

Descripción

For converting pneumatic to electrical signals. Designed for use in rough vacuum applications (technical vacuum). Universal switch type, suitable as NC, NO or changeover contact. These devices are free from paint-wetting impairment substances (PWIS).

Artículo

Denominación	Conexión	Rango de ajuste	A (mm)	B (mm)
K- 07 30 28 45	G 1/4	0,2 - 2,0 bar	48,0	28,0
K- 07 30 28 46	G 1/4	0,5 - 8,0 bar	48,0	28,0
K- 07 30 28 47	G 1/4	1,0 - 16,0 bar	48,0	28,0