

K-MUFFEN RUND KURZ

Sockets, round, short type

HANSA FLEX

Características

Presión de funcionamiento	Max. 20 bar
Rosca interior	Parallel to DIN EN ISO 228-1
Material	Stainless steel 1.4408

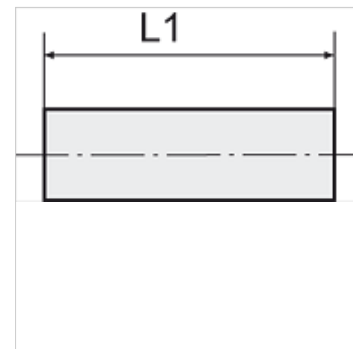

Nota

The dimensions of the standard screw fittings may change slightly during the life of the catalogue as a result of optimisation processes.
Otras especificaciones a petición.

Artículo

Denominación	Rosca	L1 (mm)
K- 07 40 14 97	G 1/8	7,2
K- 07 40 14 98	G 1/4	11,2
K- 07 40 14 99	G 3/8	11,8
K- 07 40 15 00	G 1/2	15,0
K- 07 40 15 01	G 3/4	16,0
K- 07 40 15 02	G 1	20,3
K- 07 40 15 03	G 1 1/4	22,4
K- 07 40 15 04	G 1 1/2	22,0
K- 07 40 15 05	G 2	26,0