

K-VHR IS BUND ES

Hexagon socket screw plugs with collar

HANSA FLEX

Características

| | |
|---------------------------|-------------------------------------|
| Presión de funcionamiento | Max. 20 bar |
| Construcción | Tapón roscado con hexágono interior |
| Material | Acero fino 1.4571 |

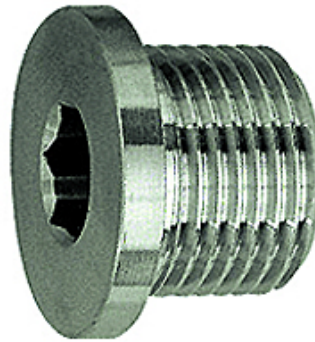

Nota

The dimensions of the standard screw fittings may change slightly during the life of the catalogue as a result of optimisation processes. Otras especificaciones a petición.

Información adicional

Further types and dimensions on request.

Artículo

| Denominación | Rosca | L1 (mm) | L2 (mm) | SW |
|----------------|-------|------------|------------|-------|
| K- 07 40 39 65 | G 1/8 | 11,0 | 8,0 | 5 mm |
| K- 07 40 39 66 | G 1/4 | 13,0 | 10,0 | 6 mm |
| K- 07 40 39 67 | G 3/8 | 15,0 | 12,0 | 8 mm |
| K- 07 40 39 68 | G 1/2 | 18,0 | 14,0 | 10 mm |
| K- 07 40 45 22 | G 3/4 | 20,0 | 16,0 | 12 mm |
| K- 07 40 45 25 | G 1 | 21,0 | 16,0 | 17 mm |