

K-UEM MS NI

Hexagonal swivel nuts - nickel plated brass

HANSA FLEX

Características

| | |
|-------------------------|-----------------|
| Temperatura de servicio | Max. 150 °C |
| Presión | Max. 60 bar |
| Material | Latón niquelado |

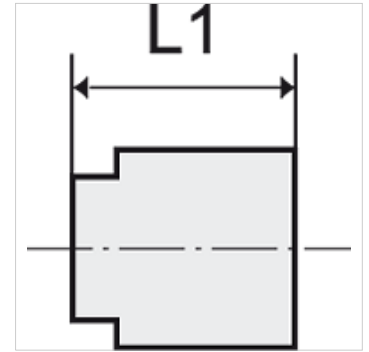
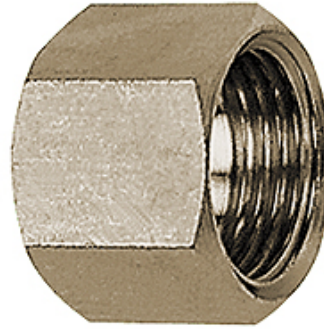

Nota

The dimensions of the standard screw fittings may change slightly during the life of the catalogue as a result of optimisation processes. Otras especificaciones a petición.

Descripción

Suitable for air, water, oil, steam, etc.

Información adicional

Further types and dimensions on request.

Artículo

| Denominación | Rosca | para tamaño de manguito | L1 (mm) | SW |
|----------------|-------|-------------------------|------------|-------|
| K- 07 40 44 22 | G 1/8 | I.D. 4, I.D. 6 | 13,0 | 14 mm |
| K- 07 40 44 23 | G 1/4 | I.D. 4, I.D. 6 | 15,0 | 17 mm |
| K- 07 40 44 24 | G 3/8 | I.D. 9 | 15,0 | 19 mm |
| K- 07 40 44 25 | G 1/2 | I.D. 4, I.D. 6, I.D. 9 | 16,0 | 24 mm |