

# K-VERSCHRAUBUNGEN PFA

Unions - Perfluoroalkoxy alkane (PFA)

**HANSA FLEX**

## Características

<b>Presión de servicio</b>	Dependent on operating temperature; Max. 10 bar (at 20 °C); Max. 1 bar (at 170 °C)
<b>Temperatura de servicio</b>	Max. 200 °C
<b>Material</b>	Perfluoroalkoxy alkane (PFA)

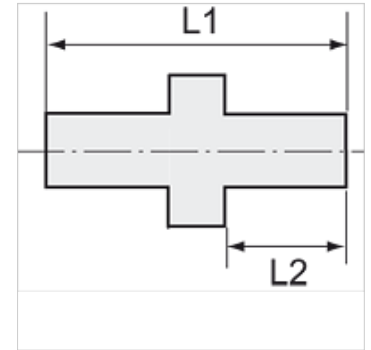
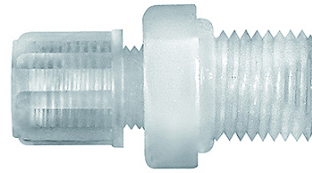

## Nota

Otras especificaciones a petición.

## Descripción

Perfluoroalkoxy alkane (PFA): A fluoroplastic (PTFE) with the same chemical resistance as PTFE but much stronger and suitable for temperatures up to 200°C.

## Artículo

Denominación	Rosca	para tubo flexible	L1 (mm)	L2 (mm)	SW
K- 07 40 40 97	G 1/8	4 mm / 6 mm	31,5	8,0	14 mm
K- 07 40 40 99	G 1/8	6 mm / 8 mm	36,5	8,0	17 mm
K- 07 40 41 01	G 1/8	8 mm / 10 mm	40,5	8,0	19 mm
K- 07 40 41 04	G 1/4	4 mm / 6 mm	37,0	12,0	17 mm
K- 07 40 41 06	G 1/4	6 mm / 8 mm	41,0	12,0	17 mm
K- 07 40 41 08	G 1/4	8 mm / 10 mm	45,0	12,0	19 mm
K- 07 40 41 10	G 1/4	9 mm / 12 mm	48,5	12,0	22 mm
K- 07 40 41 12	G 3/8	4 mm / 6 mm	38,5	12,0	22 mm
K- 07 40 41 14	G 3/8	6 mm / 8 mm	42,5	12,0	22 mm
K- 07 40 41 16	G 3/8	8 mm / 10 mm	45,5	12,0	22 mm
K- 07 40 41 18	G 3/8	9 mm / 12 mm	49,5	12,0	22 mm
K- 07 40 41 20	G 1/2	4 mm / 6 mm	43,0	14,0	27 mm
K- 07 40 41 22	G 1/2	6 mm / 8 mm	47,0	14,0	27 mm
K- 07 40 41 24	G 1/2	8 mm / 10 mm	50,0	14,0	27 mm
K- 07 40 41 26	G 1/2	9 mm / 12 mm	54,0	14,0	27 mm