

# K-MV G (NC) D 230 V, 50 HZ H

Normally closed, (NC), directly operated, 230 V, 50 Hz, for high pressures

**HANSA FLEX**

## Características

<b>Conexión eléctrica</b>	device socket type A in acc. with ISO 4400 for all valves with threads G 3/8 & G 1/2, except valves type 3 & 4. Device socket
<b>Tipo de protecc.</b>	IP 65
<b>Temper. de medios</b>	max. 80 °C when using water or oils; max. 90 °C when using with air
<b>Descripción de rosca</b>	G thread acc. DIN EN ISO 228-1
<b>Carcasa, asiento de vál.</b>	Brass
<b>Piezas int.</b>	Stainless steel
<b>Obturac.</b>	FPM

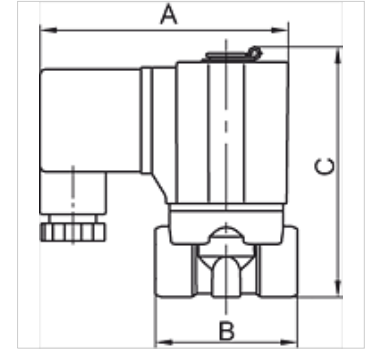

## Nota

Otras especificaciones a petición.

## Descripción

Standard series in two different versions: Directly operated, Pilot-operated. For all applications with compressed air, neutral gases or low-viscosity, neutral media.

## Artículo

Denominación	Rosca	Presión de servicio máx. (bar)	NW	A (mm)	B (mm)	C (mm)	Forma constructiva
K- 07 30 01 60	G 1/8	30	1,5	70,0	40,0	70,7	1
K- 07 30 01 61	G 1/4	30	1,5	70,0	40,0	70,7	1
K- 07 30 01 62	G 3/8	30	3,0	85,0	52,0	87,0	1
K- 07 30 01 63	G 1/2	30	3,0	85,0	52,0	87,0	1