

# K-L-STECKVER L DREH MINI

Male elbows, long, swivel type, mini

**HANSA FLEX**

## Características

Presión de funcionamiento	Max. 10 bar, vacuum
Campo de aplicación	Air, vacuum
Mangueras recomendadas	PU or PA (nylon)
Medios	aire comprimido
Norma	M thread acc. to DIN 13-1, with O-Ring G thread acc. to DIN EN ISO 228-1, with O-Ring R thread acc. to ISO 7-1, thread coating
Rango de temperatura	0 °C to +60 °C
Superficie de obturación	O-ring (NBR)
Material	Plastic, Nickel plated brass
Anillo de presión	Plastic

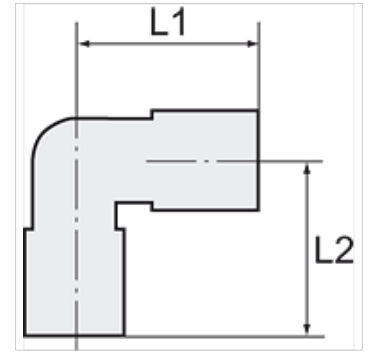

## Nota

Otras especificaciones a petición.

## Descripción

Push-in fittings series manufactured in plastic and nickel-plated brass, space-saving miniature design.

## Artículo

Denominación	Rosca	para Ø exterior de tubo flexible	L1 (mm)	L2 (mm)	SW
K- 07 40 23 53	M 3	3 mm	12,0	24,0	8 mm
K- 07 40 23 54	M 3	4 mm	14,0	29,2	8 mm
K- 07 40 23 55	M 5	3 mm	12,0	24,0	8 mm
K- 07 40 23 56	M 5	4 mm	14,0	29,2	8 mm
K- 07 40 23 57	M 5	6 mm	16,0	29,2	8 mm
K- 07 40 23 58	M 6	3 mm	12,0	24,5	10 mm
K- 07 40 23 59	M 6	4 mm	14,0	29,6	10 mm
K- 07 40 23 60	M 6	6 mm	16,0	29,6	10 mm
K- 07 40 23 61	G 1/8	4 mm	14,0	28,5	14 mm
K- 07 40 23 62	G 1/8	6 mm	16,0	28,5	14 mm
K- 07 40 23 63	R 1/8	4 mm	14,0	30,0	10 mm
K- 07 40 23 64	R 1/8	6 mm	16,0	30,0	10 mm