

# K-W90 DREH AG OR MS

Male elbows, swivel type, parallel male thread with O-ring (M5 - non-swivel type, w/o O-ring)

**HANSA FLEX**

## Características

|                           |                 |
|---------------------------|-----------------|
| Presión de funcionamiento | Max. 18 bar     |
| Material obturador        | Buna-N          |
| Material                  | Latón niquelado |

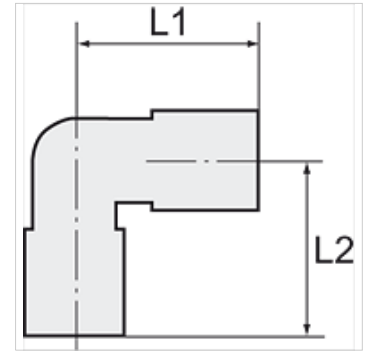

## Nota

Otras especificaciones a petición.

## Artículo

| Denominación   | Rosca | para tubo flexible | L1<br>(mm) | L2<br>(mm) | SW    |
|----------------|-------|--------------------|------------|------------|-------|
| K- 07 40 41 30 | M 5   | 5 mm / 3 mm        | 21,5       | 15,0       | 8 mm  |
| K- 07 40 31 48 | G 1/8 | 6 mm / 4 mm        | 20,5       | 21,0       | 13 mm |
| K- 07 40 31 50 | G 1/8 | 8 mm / 6 mm        | 21,0       | 21,0       | 13 mm |
| K- 07 40 31 44 | G 1/4 | 6 mm / 4 mm        | 21,5       | 22,5       | 16 mm |
| K- 07 40 31 46 | G 1/4 | 8 mm / 6 mm        | 22,0       | 24,0       | 16 mm |
| K- 07 40 31 42 | G 1/4 | 10 mm / 8 mm       | 24,0       | 24,0       | 16 mm |