

### Omadused

|                   |                                    |
|-------------------|------------------------------------|
| Ühendus 1         | BSPT-väliskeere, kooniline         |
| Tihenditüüp 1     | Keermestihend                      |
| Ühendus 2 + 3     | M-keere välis, silindriline        |
| Tihenditüüp 2 + 3 | 24° sisekoonus                     |
| Tüüp              | Sissekeeratav liitmik .            |
| Ehitustüüp        | T-kujuline                         |
| Tavaline          | DIN 2353<br>ISO 8434-1             |
| Komplektis        | Torumutri ja lõikurrõngaga liitmik |
| Materjal          | Teras                              |
| Pinnatöötlus      | galvaniseeritud                    |

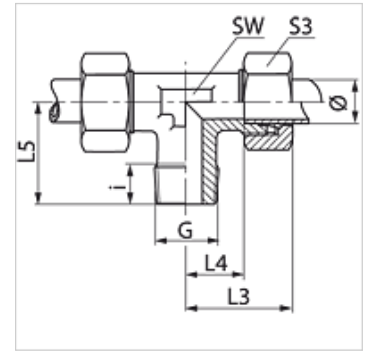

### Vihje

Viiteid monteerimise, paigaldamise, survetugevuse ja lubatud töötemperatuuride kohta leiate toruühenduste tehnilisest juhendist.

### Artikkel

| Märgistus   | Ehitusseeria | Töörõhk bar | Toru välimine Ø (mm) | G        | i (mm) | L3 (mm) | L4 (mm) | L5 (mm) | SW (mm) | S3 |
|-------------|--------------|-------------|----------------------|----------|--------|---------|---------|---------|---------|----|
| TR 04 LL    | LL           | PN 100      | 4                    | R 1/8" K | 8      | 21      | 11,0    | 17      | 9       | 10 |
| TR 05 LL    | LL           | PN 100      | 5                    | R 1/8" K | 8      | 21      | 9,5     | 17      | 11      | 12 |
| TR 06 LL    | LL           | PN 100      | 6                    | R 1/8" K | 8      | 21      | 9,5     | 17      | 9       | 12 |
| TR 08 LL    | LL           | PN 100      | 8                    | R 1/8" K | 8      | 23      | 11,5    | 20      | 12      | 14 |
| TR 10 LL    | LL           | PN 100      | 10                   | R 1/4" K | 12     | 24      | 12,5    | 11      | 14      | 17 |
| TR 12 LL    | LL           | PN 100      | 12                   | R 1/4" K | 12     | 25      | 13,0    | 11      | 17      | 19 |
| TR NW 04 HL | L            | PN 315      | 6                    | R 1/8" K | 8      | 27      | 12,0    | 20      | 12      | 14 |
| TR NW 06 HL | L            | PN 315      | 8                    | R 1/4" K | 12     | 29      | 14,0    | 26      | 12      | 17 |
| TR NW 08 HL | L            | PN 315      | 10                   | R 1/4" K | 12     | 30      | 15,0    | 27      | 14      | 19 |
| TR NW 10 HL | L            | PN 315      | 12                   | R 3/8" K | 12     | 32      | 17,0    | 28      | 17      | 22 |
| TR NW 13 HL | L            | PN 315      | 15                   | R 1/2" K | 14     | 36      | 21,0    | 34      | 19      | 27 |
| TR NW 16 HL | L            | PN 315      | 18                   | R 1/2" K | 14     | 40      | 23,5    | 36      | 24      | 32 |
| TR NW 03 HS | S            | PN 400      | 6                    | R 1/4" K | 12     | 31      | 16,0    | 26      | 12      | 17 |
| TR NW 04 HS | S            | PN 400      | 8                    | R 1/4" K | 12     | 32      | 17,0    | 27      | 14      | 19 |
| TR NW 06 HS | S            | PN 400      | 10                   | R 3/8" K | 12     | 34      | 17,5    | 28      | 17      | 22 |
| TR NW 08 HS | S            | PN 400      | 12                   | R 3/8" K | 12     | 38      | 21,5    | 28      | 17      | 24 |
| TR NW 10 HS | S            | PN 400      | 14                   | R 1/2" K | 14     | 40      | 22,0    | 32      | 19      | 27 |
| TR NW 13 HS | S            | PN 400      | 16                   | R 1/2" K | 14     | 43      | 24,5    | 32      | 24      | 30 |

Ø = toru välisläbimõõt – Ehitusseeria: LL = väga kerge L = kerge S = raske – PN = nimirõhk PB = maks. töörõhk

### Toote variandid

|        |   |
|--------|---|
| TRK MG | Sissekeeratav ühendus, T-kujuline, Messing          |
| TRK VA | Sissekeeratav ühendus, T-kujuline, Roostevaba teras |
| XTRK   | Sissekeeratav liitmik, T-kujuline, Teras            |