

Omadused

| | |
|---------------|---------------------------------------|
| Ühendus 1 | BSP-sisekeere, silindriline |
| Tihenditüüp 1 | A-vorm |
| Ühendus 2 | M-keere välis, silindriline |
| Tihenditüüp 2 | 24° sisekoonus |
| Tüüp | Pealekeeratav liitmik . |
| Ehitustüüp | Sirge |
| Tavaline | DIN 2353 ISO 8434-1 |
| Komplektis | Liitmik (ilma mutri ja lõikurrõngata) |
| Materjal | Roostevaba teras |

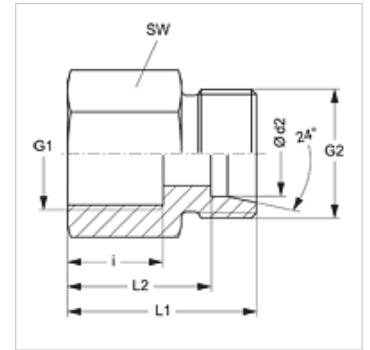

Vihje

Viiteid monteerimise, paigaldamise, survetugevuse ja lubatud töötemperatuuride kohta leiata toruühenduste tehnilisest juhendist.

Artikkel

| Märgistus | Ehitusseeria | Töörõhk bar | Ø d2 (mm) | G1 | G2 | i (mm) | L1 (mm) | L2 (mm) | SW (mm) |
|----------------------|--------------|-------------|-----------|--------------|------------|--------|---------|---------|---------|
| XGAR NW 04 HL VA | L | PN 315 | 6 | G 1/8" -28 | M 12 x 1,5 | 12,0 | 26,0 | 19,0 | 14 |
| XGAR NW 04 HL 1/4 VA | L | PN 315 | 6 | G 1/4" -19 | M 12 x 1,5 | 17,0 | 31,0 | 24,0 | 19 |
| XGAR NW 04 HL 3/8 VA | L | PN 315 | 6 | G 3/8" -19 | M 12 x 1,5 | 17,0 | 32,0 | 25,0 | 22 |
| XGAR NW 04 HL 1/2 VA | L | PN 315 | 6 | G 1/2" -14 | M 12 x 1,5 | 20,0 | 36,0 | 29,0 | 27 |
| XGAR NW 06 HL VA | L | PN 315 | 8 | G 1/4" -19 | M 14 x 1,5 | 17,0 | 31,0 | 24,0 | 19 |
| XGAR NW 06 HL 3/8 VA | L | PN 315 | 8 | G 3/8" -19 | M 14 x 1,5 | 17,0 | 32,0 | 25,0 | 22 |
| XGAR NW 06 HL 1/2 VA | L | PN 315 | 8 | G 1/2" -14 | M 14 x 1,5 | 20,0 | 36,0 | 29,0 | 27 |
| XGAR NW 08 HL VA | L | PN 315 | 10 | G 1/4" -19 | M 16 x 1,5 | 17,0 | 32,0 | 25,0 | 19 |
| XGAR NW 08 HL 3/8 VA | L | PN 315 | 10 | G 3/8" -19 | M 16 x 1,5 | 17,0 | 33,0 | 26,0 | 22 |
| XGAR NW 08 HL 1/2 VA | L | PN 315 | 10 | G 1/2" -14 | M 16 x 1,5 | 20,0 | 37,0 | 30,0 | 27 |
| XGAR NW 10 HL 1/4 VA | L | PN 315 | 12 | G 1/4" -19 | M 18 x 1,5 | 17,0 | 32,0 | 25,0 | 19 |
| XGAR NW 10 HL VA | L | PN 315 | 12 | G 3/8" -19 | M 18 x 1,5 | 17,0 | 33,0 | 26,0 | 22 |
| XGAR NW 10 HL 1/2 VA | L | PN 315 | 12 | G 1/2" -14 | M 18 x 1,5 | 20,0 | 37,0 | 30,0 | 27 |
| XGAR NW 13 HL 3/8 VA | L | PN 315 | 15 | G 3/8" -19 | M 22 x 1,5 | 17,0 | 34,0 | 27,0 | 24 |
| XGAR NW 13 HL VA | L | PN 315 | 15 | G 1/2" -14 | M 22 x 1,5 | 20,0 | 38,0 | 31,0 | 27 |
| XGAR NW 16 HL 3/8 VA | L | PN 315 | 18 | G 3/8" -19 | M 26 x 1,5 | 17,0 | 35,0 | 27,5 | 27 |
| XGAR NW 16 HL VA | L | PN 315 | 18 | G 1/2" -14 | M 26 x 1,5 | 20,0 | 38,0 | 30,5 | 27 |
| XGAR NW 20 HL 1/2 VA | L | PN 160 | 22 | G 1/2" -14 | M 30 x 2 | 20,0 | 41,0 | 33,5 | 32 |
| XGAR NW 20 HL VA | L | PN 160 | 22 | G 3/4" -14 | M 30 x 2 | 22,0 | 43,0 | 35,5 | 32 |
| XGAR NW 25 HL VA | L | PN 160 | 28 | G 1" -11 | M 36 x 2 | 24,5 | 45,5 | 38,0 | 41 |
| XGAR NW 32 HL VA | L | PN 160 | 35 | G 1.1/4" -11 | M 45 x 2 | 26,5 | 51,5 | 41,0 | 50 |
| XGAR NW 40 HL VA | L | PN 160 | 42 | G 1.1/2" -11 | M 52 x 2 | 28,5 | 53,5 | 42,5 | 55 |
| XGAR NW 03 HS 1/8 VA | S | PN 400 | 6 | G 1/8" -28 | M 14 x 1,5 | 12,0 | 28,0 | 21,0 | 17 |
| XGAR NW 03 HS VA | S | PN 630 | 6 | G 1/4" -19 | M 14 x 1,5 | 17,0 | 33,0 | 26,0 | 19 |
| XGAR NW 04 HS VA | S | PN 630 | 8 | G 1/4" -19 | M 16 x 1,5 | 17,0 | 33,0 | 26,0 | 19 |
| XGAR NW 06 HS VA | S | PN 630 | 10 | G 3/8" -19 | M 18 x 1,5 | 17,0 | 34,0 | 26,5 | 24 |
| XGAR NW 06 HS 1/2 VA | S | PN 400 | 10 | G 1/2" -14 | M 18 x 1,5 | 20,0 | 38,0 | 30,5 | 27 |
| XGAR NW 08 HS 1/4 VA | S | PN 400 | 12 | G 1/4" -19 | M 20 x 1,5 | 17,0 | 34,0 | 26,5 | 24 |
| XGAR NW 08 HS VA | S | PN 630 | 12 | G 3/8" -19 | M 20 x 1,5 | 17,0 | 34,0 | 26,5 | 24 |
| XGAR NW 08 HS 1/2 VA | S | PN 400 | 12 | G 1/2" -14 | M 20 x 1,5 | 20,0 | 38,0 | 30,5 | 27 |
| XGAR NW 10 HS VA | S | PN 630 | 14 | G 1/2" -14 | M 22 x 1,5 | 20,0 | 40,0 | 32,0 | 27 |
| XGAR NW 13 HS VA | S | PN 400 | 16 | G 1/2" -14 | M 24 x 1,5 | 20,0 | 40,0 | 31,5 | 27 |
| XGAR NW 16 HS 3/8 VA | S | PN 315 | 20 | G 3/8" -19 | M 30 x 2 | 17,0 | 38,0 | 27,5 | 36 |
| XGAR NW 16 HS 1/2 VA | S | PN 315 | 20 | G 1/2" -14 | M 30 x 2 | 20,0 | 43,0 | 31,5 | 36 |
| XGAR NW 16 HS VA | S | PN 400 | 20 | G 3/4" -14 | M 30 x 2 | 22,0 | 45,0 | 34,5 | 36 |
| XGAR NW 20 HS VA | S | PN 400 | 25 | G 1" -11 | M 36 x 2 | 24,5 | 49,5 | 37,5 | 41 |
| XGAR NW 25 HS VA | S | PN 400 | 30 | G 1.1/4" -11 | M 42 x 2 | 26,5 | 55,5 | 42,0 | 50 |
| XGAR NW 32 HS VA | S | PN 315 | 38 | G 1.1/2" -11 | M 52 x 2 | 28,5 | 59,5 | 43,5 | 60 |

Ehitusseeria: LL = väga kerge L = kerge S = raske - PN = nimirõhk PB = maks. tööõhk - Ø d2 = toru välisläbimõõt

Toote variandid

| | |
|--------|---|
| XGAR | Peale keeratav liitmik, Teras |
| GAR VA | Pealekeeratav kruvikinnitus, Roostevaba teras |