

Omadused

| | |
|---------------|---------------------------------------|
| Ühendus 1 | NPT-sisekeere |
| Tihenditüüp 1 | Tihendirõngas |
| Ühendus 2 | M-keere välis, silindriline |
| Tihenditüüp 2 | 24° sisekoonus |
| Tüüp | Manomeetri liitmik |
| Komplektis | Liitmik (ilma mutri ja lõikurrõngata) |
| Materjal | Roostevaba teras |

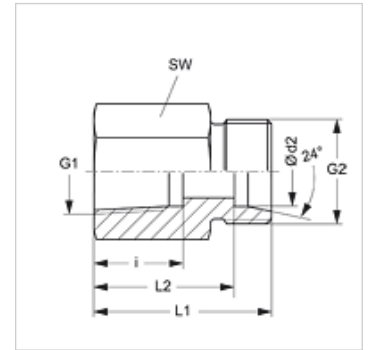

Vihje

Viiteid monteerimise, paigaldamise, survetugevuse ja lubatud töötemperatuuride kohta leiata toruühenduste tehnilisest juhendist.

Artikkel

| Märgistus | Ehitusseeria | Ø d2 (mm) | Töörõhk bar | G1 | G2 | i (mm) | L1 (mm) | L2 (mm) | SW (mm) |
|----------------------|--------------|-----------|-------------|--------------|------------|--------|---------|---------|---------|
| XMVN NW 04 HL VA | L | 6 | PN 315 | 1/4" -18 NPT | M 12 x 1,5 | 16,4 | 30,5 | 23,5 | 19 |
| XMVN NW 04 HL 1/2 VA | L | 6 | PN 315 | 1/2" -14 NPT | M 12 x 1,5 | 22,5 | 38,0 | 31,0 | 27 |
| XMVN NW 06 HL VA | L | 8 | PN 315 | 1/4" -18 NPT | M 14 x 1,5 | 16,4 | 30,5 | 23,5 | 19 |
| XMVN NW 06 HL 1/2 VA | L | 8 | PN 315 | 1/2" -14 NPT | M 14 x 1,5 | 22,6 | 38,0 | 31,0 | 27 |
| XMVN NW 08 HL VA | L | 10 | PN 315 | 1/4" -18 NPT | M 16 x 1,5 | 16,4 | 31,0 | 24,0 | 19 |
| XMVN NW 08 HL 1/2 VA | L | 10 | PN 315 | 1/2" -14 NPT | M 16 x 1,5 | 22,6 | 39,0 | 32,0 | 27 |
| XMVN NW 10 HL VA | L | 12 | PN 315 | 1/4" -18 NPT | M 18 x 1,5 | 16,4 | 31,0 | 24,0 | 19 |
| XMVN NW 10 HL 1/2 VA | L | 12 | PN 315 | 1/2" -14 NPT | M 18 x 1,5 | 22,6 | 39,0 | 32,0 | 27 |
| XMVN NW 03 HS VA | S | 6 | PN 630 | 1/2" -14 NPT | M 14 x 1,5 | 22,6 | 40,0 | 33,0 | 27 |
| XMVN NW 04 HS VA | S | 8 | PN 630 | 1/2" -14 NPT | M 16 x 1,5 | 22,6 | 40,0 | 33,0 | 27 |
| XMVN NW 06 HS VA | S | 10 | PN 630 | 1/2" -14 NPT | M 18 x 1,5 | 22,6 | 40,0 | 32,5 | 27 |
| XMVN NW 08 HS VA | S | 12 | PN 630 | 1/2" -14 NPT | M 20 x 1,5 | 22,6 | 40,0 | 32,5 | 27 |

Ehitusseeria: LL = väga kerge L = kerge S = raske – PN = nimirõhk PB = maks. töörõhk – Ø = toru välisläbimõõt

Toote variandid

MVN VA Manomeeter-krükikinnitus, tihendirõngaga

Varuosad

DKI VA Tihendirõngas sisekeermele