

K-VAKUUMSCHALTER

Vacuum switch

HANSA FLEX

Omadused

Mõõteaine ühendus	G 1/8 male and M 5 female
Väljundsignaal	Analogue: 1 to 5 V
Elektriühendus	Male connector M8, four pin
Hüsterees	Adjustable: 3 to 25% of set value
Vahendid	Non-aggressive gases. dry, oil-free air
Lülitusfunktsioon	PNP
Lülitusvõime	125 mA
Voolutarve	30 mA
Temperatuuri ulatus	0 - 50 °C
Korpus	Polycarbonate

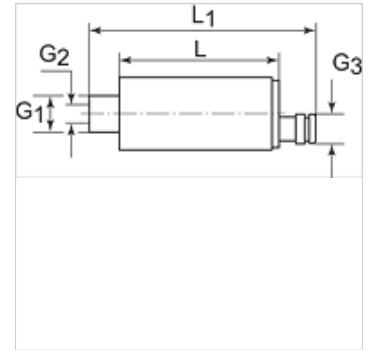

Vihje

Lisaandmed saate soovi korral.

Kirjeldus

Universal electronic vacuum switch for safety monitoring, optimisation of cycle times and regulation circuits. Its small size and low weight permit installation directly on the suction pad.
Switching point and hysteresis adjustable with a screw. Integrated LED for indication of the switching state.

Artikkel

Märgistus	Väline G1	Sisemine G2	Väline G3	L (mm)	L1 (mm)	Mõõteulatus	Pinge
K- 07 45 01 58	G 1/8	M 5	M 8 x 1	44,0	62,0	-1 bis 0 bar	10.8 - 30 V DC