

# K-VAKUUMSENSOR ANALOG

Vacuum sensor, analogue

**HANSA FLEX**

## Omadused

<b>Rakendus</b>	Measurement of vacuum values close to the suction pad Remote evaluation of the signals Processing the output signals, for example, by PLC
<b>Vahendid</b>	dry, oil-free air and non-aggressive gases
<b>Temperatuuri ulatus</b>	0 - 50 °C
<b>Väljundsignaal</b>	1 to 5 analogous to V
<b>Hüsterees</b>	Fixed: 20 mbar (model with digital sensor)
<b>Kaabli pikkus</b>	3 m
<b>Kaitse tüüp</b>	IP 40

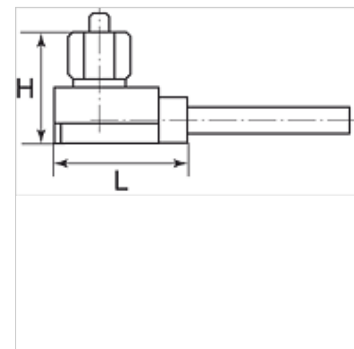

## Vihje

Lisaandmed saate soovi korral.

## Kirjeldus

Mini-sensor with housing and connection cable, analogue or digital output signal. Minimum size and low weight combined with high measuring accuracy.

## Artikkel

Märgistus	Ühendus	H (mm)	L (mm)	Mõõteulatus	Pinge
K- 07 45 01 56	M 5 male	16,9	21,0	-1 bis 0 bar	10 - 24 V DC