

K-DRS ELK GERAETESTECKER

Pressure switches, connection with plug connector, type A acc. to DIN 43650

HANSA FLEX

Omadused

| | |
|---------------------|-------------------------------------|
| Rakendusvaldkond | Pneumatic applications |
| Lülitussagedus | 200/min. |
| Lülituspinge | max. 250 V AC / 28 V DC |
| Kaitse tüüp | IP 65 (DIN 43650), IP 67 (M 12 x 1) |
| Temperatuuri ulatus | -10 °C to +80 °C |
| Reguleerimiskork | Aluminium, powder-coated |
| Korpus | Special die-cast material |
| Membran, tihend | NBR |

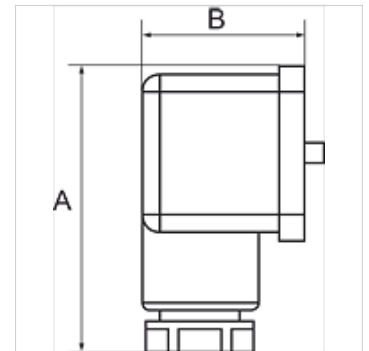

Vihje

Lisaandmed saate soovi korral.

Kirjeldus

For converting pneumatic to electrical signals. Designed for use in rough vacuum applications (technical vacuum). Universal switch type, suitable as NC, NO or changeover contact. These devices are free from paint-wetting impairment substances (PWIS).

Artikkel

| Märgistus | Ühendus | Seadistusvahemik | A (mm) | B (mm) |
|----------------|---------|------------------|-----------|-----------|
| K- 07 30 28 45 | G 1/4 | 0,2 - 2,0 bar | 48,0 | 28,0 |
| K- 07 30 28 46 | G 1/4 | 0,5 - 8,0 bar | 48,0 | 28,0 |
| K- 07 30 28 47 | G 1/4 | 1,0 - 16,0 bar | 48,0 | 28,0 |