

K-DRS ELK ANSCHLUSS M 1

Pressure switches, electrical connection M 12 x 1

Omadused

Rakendusvaldkond	Pneumatic applications
Lülitussagedus	200/min.
Lülituspinge	max. 250 V AC / 28 V DC
Kaitse tüüp	IP 65 (DIN 43650), IP 67 (M 12 x 1)
Temperatuuri ulatus	-10 °C to +80 °C
Reguleerimiskork	Aluminium, powder-coated
Korpus	Special die-cast material
Membran, tihend	NBR

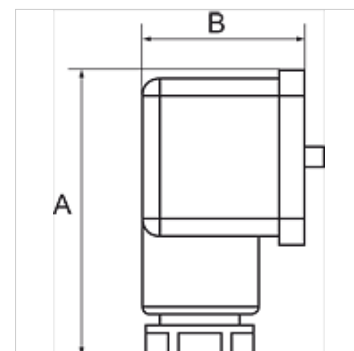

Vihje

Lisaandmed saate soovi korral.

Kirjeldus

For converting pneumatic to electrical signals. Designed for use in rough vacuum applications (technical vacuum). Universal switch type, suitable as NC, NO or changeover contact. These devices are free from paint-wetting impairment substances (PWIS).

Artikkel

Märgistus	Ühendus	Seadistusvahemik	A (mm)	B (mm)
K- 07 30 28 48	G 1/4	0,2 - 2,0 bar	48,0	28,0
K- 07 30 28 49	G 1/4	0,5 - 8,0 bar	48,0	28,0
K- 07 30 28 50	G 1/4	1,0 - 16,0 bar	48,0	28,0