

# K-W90 AG-K

Male elbows, conical male thread

**HANSA FLEX**

## Omadused

Töörõhk	Max. 16 bar (at +20 °C)
Töötemperatuur	-20 °C to +70 °C
Materjal	Nikeldatud messing
Surverõngas	Hostaform (black nickel-plated for Ø 10, 12)
O-rõngas	NBR, siliconefree
Pingutustangid	Stainless steel AISI 316

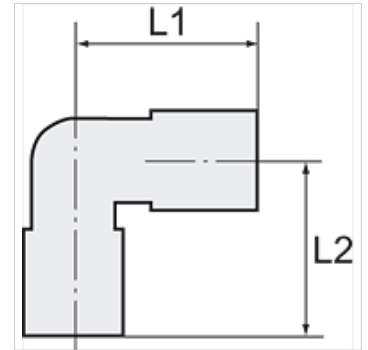

## Vihje

Lisaandmed saate soovi korral.

## Kirjeldus

Economy yet very high-quality series of push-in fittings made of nickel-plated brass. Compact, space-saving, lightweight design. An O-ring in the fillet at the end of the thread guarantees a tight connection for all male thread parts, even on rough surfaces.

## Artikkel

Märgistus	Keere	vooliku välimise-Ø jaoks (mm)	L1 (mm)	L2 (mm)	SW
K- 07 40 29 65	R 1/8	4 mm	16,1	17,5	10 mm
K- 07 40 29 66	R 1/8	6 mm	20,0	17,5	10 mm
K- 07 40 29 67	R 1/8	8 mm	24,0	18,5	10 mm
K- 07 40 29 63	R 1/4	6 mm	23,0	22,0	12 mm
K- 07 40 29 64	R 1/4	8 mm	24,0	22,0	12 mm
K- 07 40 29 62	R 1/4	10 mm	24,0	22,0	14 mm