

K-3/2-BKR MULTIFIX MINI

Ball valves

HANSA FLEX

Omadused

Aine temperatuur	max. 60 °C
Keskonnatemperatuur	Max. 60 °C
Rakendus	Twist knob, rotatable 90°
Läbivool	1800 l/min
Õhutusühendus	Silencer G 1/4
Tihendusmaterjal	NBR
Korpus	Die-cast zinc
Läbivoolu väärtuse mõõtmine	At P1 = 6 bar and pressure drop $\Delta p = 1$ bar

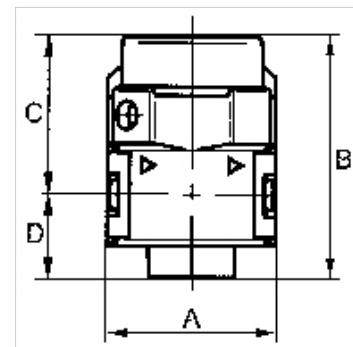
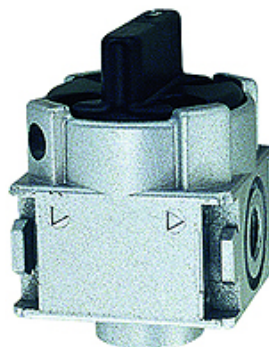

Vihje

If several devices in the »multifix-mini« Series are assembled together, the maximum working pressure is 12 bar.

Lisaandmed saate soovi korral.

Kirjeldus

Rotary switch can be turned 90°, lockable, with relief port

Artikkel

Märgistus	Keere	A (mm)	B	C (mm)	D (mm)	Ehitussuurus
K- 07 25 11 56	G 1/8	40,0	57,6 mm	37,6	20,0	0
K- 07 25 11 57	G 1/4	40,0	57,6 mm	37,6	20,0	0

Varuosad

K-KOPPELPAKET MEHR	Coupling packet
K-AUTOMAT ABLASSVENTIL	Automatic drain valve
K-SCHALLDAE SINTERBR SCHLITZ	Silencers, sintered bronze, slotted