

# K-X-STECKVERBINDUNG 1

X-unions

**HANSA FLEX**

## Omadused

Töörõhk	Max. 16 bar
Töötemperatuur	-20 °C to +80 °C
Materjal	Nikeldatud messing
Surverõngas	Hostaform
Pingutusrõngas	Stainless steel

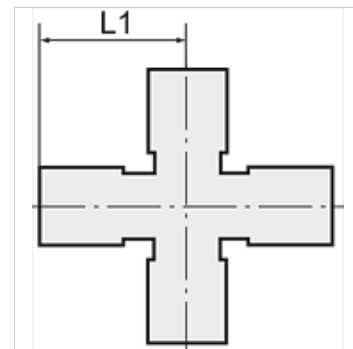
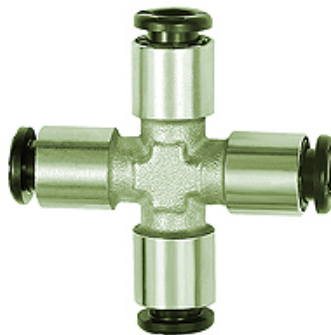

## Vihje

Lisaandmed saate soovi korral.

## Kirjeldus

The advanced version of our highly successful push-in fittings series manufactured in nickel-plated brass. Advantages of this new, optimised series: Much easier connection and disconnection of the hose, even with repeated mounting, can also be used for non-calibrated hoses, suitable for vacuum operation.

## Artikkel

Märgistus	vooliku välimise-Ø jaoks (mm)	L1 (mm)
K- 07 40 47 29	4 mm	18,6
K- 07 40 47 30	6 mm	21,9
K- 07 40 47 31	8 mm	25,4