

K-L-STECKVER ABSP DREH AG OR

Angle stop valves, swivel type, parallel male thread with O-ring

HANSA FLEX

Omadused

Töörõhk	Max. 10 bar, vacuum
Rakendusvaldkond	Air, vacuum
soovitatud voolikud	PU or PA (nylon)
Vahendid	Suruõhk
Tavaline	G thread acc. to DIN EN ISO 228-1, with O-Ring
Temperatuuri ulatus	0 °C to +60 °C
Tihenduspid	O-ring (NBR)
Materjal	Plastic, Nickel plated brass
Surverõngas	Plastic

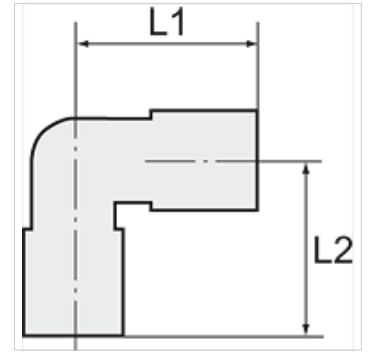

Vihje

Lisaandmed saate soovi korral.

Kirjeldus

The air supply is completely shut off as soon as the hose is disconnected from the union. The flow rate is only guaranteed if the hose is securely inserted.

Artikkel

Märgistus	Keere	vooliku välimise-Ø jaoks (mm)	L1 (mm)	L2 (mm)	SW
K- 07 40 08 46	M 5	4 mm	31,0	21,3	10 mm
K- 07 40 08 47	M 5	6 mm	29,4	21,7	12 mm
K- 07 40 08 40	G 1/8	4 mm	31,0	24,3	14 mm
K- 07 40 08 41	G 1/8	6 mm	29,4	24,2	14 mm
K- 07 40 08 42	G 1/8	8 mm	33,0	27,0	14 mm
K- 07 40 08 38	G 1/4	6 mm	29,4	26,7	17 mm
K- 07 40 08 39	G 1/4	8 mm	33,0	29,5	17 mm
K- 07 40 08 37	G 1/4	10 mm	42,5	34,3	17 mm
K- 07 40 08 45	G 3/8	8 mm	33,0	30,0	20 mm
K- 07 40 08 43	G 3/8	10 mm	42,5	34,3	20 mm
K- 07 40 08 44	G 3/8	12 mm	46,5	36,0	21 mm
K- 07 40 08 35	G 1/2	10 mm	42,5	37,8	24 mm
K- 07 40 08 36	G 1/2	12 mm	46,5	39,0	24 mm