

# K-L-STECKVER ABSP DREH AG-K

Angle stop valves, swivel type, conical male thread, coated

**HANSA FLEX**

## Omadused

Töörõhk	Max. 10 bar, vacuum
Rakendusvaldkond	Air, vacuum
soovitatud voolikud	PU or PA (nylon)
Vahendid	Suruõhk
Tavaline	R thread acc. to ISO 7-1, thread coating
Temperatuuri ulatus	0 °C to +60 °C
Tihenduspid	Conical version: thread coating
Materjal	Plastic, Nickel plated brass
Surverõngas	Plastic

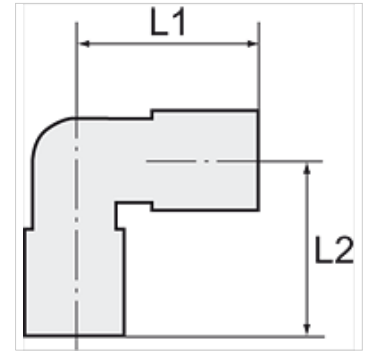

## Vihje

Lisaandmed saate soovi korral.

## Kirjeldus

The air supply is completely shut off as soon as the hose is disconnected from the union. The flow rate is only guaranteed if the hose is securely inserted.

## Artikkel

Märgistus	Keere	vooliku välimise-Ø jaoks (mm)	L1 (mm)	L2 (mm)	SW
K- 07 40 08 53	R 1/8	4 mm	31,0	23,8	10 mm
K- 07 40 08 54	R 1/8	6 mm	29,4	24,2	12 mm
K- 07 40 08 55	R 1/8	8 mm	33,0	27,5	14 mm
K- 07 40 08 51	R 1/4	6 mm	29,4	26,7	14 mm
K- 07 40 08 52	R 1/4	8 mm	33,0	29,5	14 mm
K- 07 40 08 50	R 1/4	10 mm	42,5	34,3	17 mm
K- 07 40 08 58	R 3/8	8 mm	33,0	31,0	17 mm
K- 07 40 08 56	R 3/8	10 mm	42,5	35,3	17 mm
K- 07 40 08 57	R 3/8	12 mm	46,5	37,0	21 mm
K- 07 40 08 48	R 1/2	10 mm	42,5	38,8	21 mm
K- 07 40 08 49	R 1/2	12 mm	46,5	40,0	21 mm