

# K-W90 STUECK IG IG VA

Elbows, female/female, stainless steel

**HANSA FLEX**

## Omadused

Töötemperatuur -20 °C to +150 °C

Rõhuvahemik Max. 150 bar

Sisekeere Parallel to DIN EN ISO 228-1

Materjal Roostevaba teras 1.4404

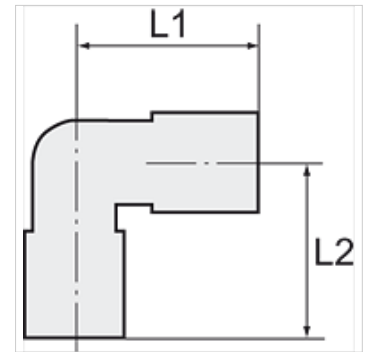

## Vihje

Lisaandmed saate soovi korral.

## Artikkel

Märgistus	Keere	L1 (mm)	L2 (mm)
K- 07 40 10 64	G 1/8	19,0	19,0
K- 07 40 10 65	G 1/4	23,0	23,0
K- 07 40 10 66	G 3/8	25,5	25,5
K- 07 40 10 67	G 1/2	32,0	32,0