

K-L-STECKVER DREH AG OR 2

Male elbows, swivel type, parallel male thread with O-ring

HANSA FLEX

Omadused

Töörõhk	Max. 16 bar
Töötemperatuur	-20 °C to +150 °C
Materjal	Nikeldatud messing
Surverõngas	Nickel-plated brass
O-rõngas	FKM (FPM)
Pingutusrõngas	Stainless steel

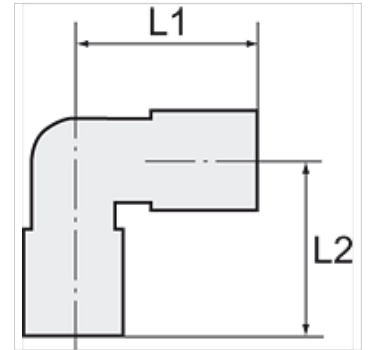

Vihje

Lisaandmed saate soovi korral.

Kirjeldus

Push-in fittings, manufactured entirely in nickel-plated brass. All parts with a parallel thread are supplied with an FPM O-ring. All parts with conical threads are coated with preCOTE 5 dispersion, all fittings in this series can thus also be used at high temperatures (medium compressed air).

Artikkel

Märgistus	Keere	vooliku välimise-Ø jaoks (mm)	L1 (mm)	L2 (mm)	SW
K- 07 40 27 65	M 5	4 mm	18,0	14,5	9 mm
K- 07 40 27 66	M 5	6 mm	21,0	14,5	9 mm
K- 07 40 27 72	G 1/8	4 mm	20,0	20,0	13 mm
K- 07 40 27 73	G 1/8	6 mm	21,0	20,0	13 mm
K- 07 40 27 74	G 1/8	8 mm	24,0	20,0	13 mm
K- 07 40 27 69	G 1/4	4 mm	20,0	24,0	13 mm
K- 07 40 27 70	G 1/4	6 mm	21,0	24,0	13 mm
K- 07 40 27 71	G 1/4	8 mm	24,0	24,0	13 mm
K- 07 40 27 68	G 1/4	10 mm	27,0	24,0	16 mm
K- 07 40 47 86	G 1/4	12 mm	29,0	30,5	16 mm
K- 07 40 27 76	G 3/8	8 mm	24,0	25,5	13 mm
K- 07 40 27 75	G 3/8	10 mm	27,0	28,0	16 mm
K- 07 40 47 85	G 1/2	12 mm	29,0	33,5	20 mm
K- 07 40 27 67	G 1/2	10 mm	27,0	30,0	16 mm
K- 07 40 47 87	G 3/8	12 mm	29,0	28,5	20 mm