

K-STECKVERSCHR IG SK 2

Female connectors, parallel female thread with outer hex

HANSA FLEX

Omadused

| | |
|---------------------|--|
| Töörõhk | Max. 15 bar, coarse vacuum |
| Rakendusvaldkond | Air, vacuum |
| soovitatud voolikud | PU or PA (nylon) |
| Vahendid | Compressed air and all gases or liquids that are compatible with the materials |
| Temperatuuri ulatus | -20 °C to +80 °C |
| Materjal | Plastic, Nickel plated brass |
| Surverõngas | Plastic |

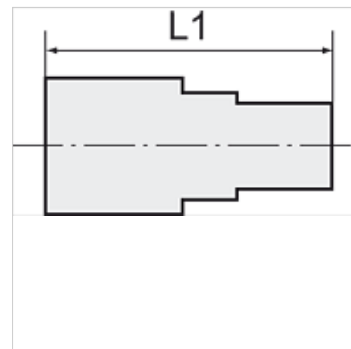
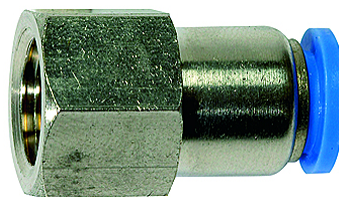

Vihje

Lisaandmed saate soovi korral.

Kirjeldus

Push-in fittings series manufactured in plastic and nickel-plated brass. All parts are suitable for use with hoses, tubes or pipes made of plastic and copper.

Artikkel

| Märgistus | Keere | vooliku välimise-Ø jaoks (mm) | L1 (mm) | SW |
|----------------|-------|-------------------------------|------------|-------|
| K- 07 40 01 20 | M 5 | 4 mm | 21,3 | 10 mm |
| K- 07 40 01 21 | M 5 | 6 mm | 22,2 | 12 mm |
| K- 07 40 01 31 | G 1/8 | 4 mm | 23,8 | 14 mm |
| K- 07 40 01 32 | G 1/8 | 6 mm | 25,2 | 14 mm |
| K- 07 40 01 33 | G 1/8 | 8 mm | 27,1 | 14 mm |
| K- 07 40 41 28 | G 1/8 | 10 mm | 28,5 | 14 mm |
| K- 07 40 01 28 | G 1/4 | 4 mm | 26,8 | 17 mm |
| K- 07 40 01 29 | G 1/4 | 6 mm | 28,2 | 17 mm |
| K- 07 40 01 30 | G 1/4 | 8 mm | 30,1 | 17 mm |
| K- 07 40 01 26 | G 1/4 | 10 mm | 32,2 | 17 mm |
| K- 07 40 01 27 | G 1/4 | 12 mm | 34,6 | 21 mm |
| K- 07 40 01 36 | G 3/8 | 6 mm | 29,2 | 21 mm |
| K- 07 40 01 37 | G 3/8 | 8 mm | 31,1 | 21 mm |
| K- 07 40 01 34 | G 3/8 | 10 mm | 33,4 | 21 mm |
| K- 07 40 01 35 | G 3/8 | 12 mm | 35,6 | 21 mm |
| K- 07 40 01 24 | G 1/2 | 6 mm | 31,2 | 24 mm |
| K- 07 40 01 25 | G 1/2 | 8 mm | 33,1 | 24 mm |
| K- 07 40 01 22 | G 1/2 | 10 mm | 35,2 | 24 mm |
| K- 07 40 01 23 | G 1/2 | 12 mm | 37,6 | 24 mm |
| K- 07 40 41 27 | G 1/2 | 16 mm | 39,7 | 24 mm |