

K-STECK VS 20-50 INFI

press-lock Ø 20 mm – Ø 63 mm

HANSA FLEX

Omadused

| | |
|---------------------|-------------------------------------|
| Vahendid | Compressed air, vacuum, inert gases |
| Töö rõhk | -0,99 bar - 15 bar |
| Temperatuuri ulatus | -20 °C to +80 °C |
| Tihend | NBR |
| Korpus | Nickel-plated brass |
| Klemmrõngas | Stainless steel 1.4301 |
| Mutter | Nickel-plated brass |
| O-rõngas | NBR |
| Kinnitusrõngas | Technopolymer |

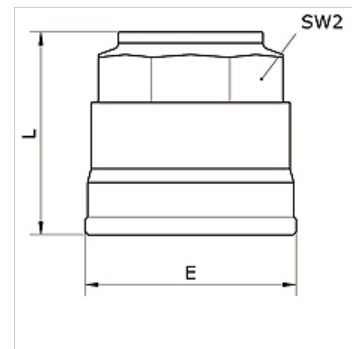

Artikkel

| Märgistus | Toru välis-Ø | E (mm) | L (mm) | SW2 (mm) |
|----------------|--------------|-----------|-----------|-------------|
| K- 07 40 54 20 | 20 mm | 34,5 | 33,0 | 30 |
| K- 07 40 54 21 | 25 mm | 42,5 | 39,0 | 35 |
| K- 07 40 54 22 | 32 mm | 52,0 | 46,5 | 45 |
| K- 07 40 54 23 | 40 mm | 63,0 | 53,0 | 55 |
| K- 07 40 54 24 | 50 mm | 73,0 | 62,0 | 65 |
| K- 07 40 55 04 | 63 mm | 94,0 | 54,0 | 75 |