

Caractéristiques

| | |
|-----------------------|----------------------------|
| Raccord 1 | filet int. UN/UNF |
| Étanchéité 1 | Cône intérieur 74° |
| Raccord 2 | filet int. BSP cylindrique |
| Étanchéité 2 | à garniture plate |
| Construction | Écrou-raccord |
| Matériau | Acier |
| Traitement de surface | revêtement galvanisé |

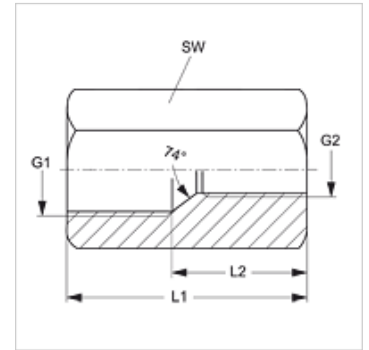

Article

| Désignation | G1 | G2 | L1 (mm) | L2 (mm) | SW (mm) |
|-----------------|----------------|------------|------------|------------|------------|
| UEM AJ 04 IR | 7/16" -20 UNF | G 1/4" -19 | 29 | - | 19 |
| UEM AJ 05 IR 04 | 1/2" -20 UNF | G 1/4" -19 | 29 | - | 19 |
| UEM AJ 06 IR 04 | 9/16" -18 UNF | G 1/4" -19 | 29 | - | 19 |
| UEM AJ 06 IR | 9/16" -18 UNF | G 3/8" -19 | 29 | - | 19 |
| UEM AJ 08 IR 04 | 3/4" -16 UNF | G 1/4" -19 | 32 | - | 22 |
| UEM AJ 08 IR | 3/4" -16 UNF | G 1/2" -14 | 32 | - | 22 |
| UEM AJ 10 IR 04 | 7/8" -14 UNF | G 1/4" -19 | 32 | - | 27 |
| UEM AJ 10 IR 08 | 7/8" -14 UNF | G 1/2" -14 | 32 | - | 27 |
| UEM AJ 12 IR 04 | 1 1/16" -12 UN | G 1/4" -19 | - | 13 | 32 |
| UEM AJ 12 IR | 1 1/16" -12 UN | G 3/4" -14 | - | 13 | 32 |
| UEM AJ 14 IR 04 | 1 3/16" -12 UN | G 1/4" -19 | - | 19 | 36 |
| UEM AJ 16 IR 04 | 1 5/16" -12 UN | G 1/4" -19 | - | 20 | 41 |
| UEM AJ 16 IR | 1 5/16" -12 UN | G 1" -11 | - | 20 | 41 |
| UEM AJ 20 IR 04 | 1 5/8" -12 UN | G 1/4" -19 | - | 20 | 50 |
| UEM AJ 24 IR 04 | 1 7/8" -12 UN | G 1/4" -19 | - | 24 | 60 |

SW, S1, S2 = largeur de clé