

Caractéristiques

| | |
|---|--|
| Construction | Bague de guidage |
| Vitesse de glissement max. | 1,0 m/s |
| Résistance à la pression selon norme DIN 53454 (N/mm ²) | 340 N/mm ² |
| Pression de Hertz | 50 N/mm ² |
| Température min. | -40 °C |
| Température max. | 130 °C |
| Médiums | Huiles minérales Émulsions aqueuses |
| Montage | Mettre dans la rainure. |
| Matériau | Stratifié de fibre synthétique et résine phénolique, avec PTFE |
| Application | Hydraulique |

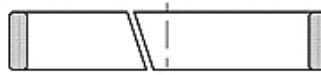

| Toleranz / Tolerance | | |
|----------------------|----|------------|
| D | d | L |
| H9 | f8 | +0,20 0 |

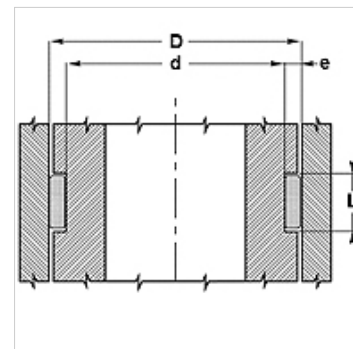

Remarque

Calcul de l'effort transversal ; $F = p \times D \times L \times n$

F = effort transversal maximal (N)

p = pression de Hertz maximale (N/mm²)

D x L = surface projetée (mm²)

n = nombre de joints

Description

simplicité de mise en œuvre et de montage du joint.

Charge admissible élevée.

faible coefficient de frottement (PTFE).

Pas d'absorption d'eau.

Longue durée de vie.

Article

| Désignation | D (mm) | d (mm) | L (mm) | Rainures selon |
|---------------------|-----------|-----------|-----------|----------------|
| EGTP1 250 560 250 A | 25 | 20 | 5,6 | ISO 10766 |
| EGTP1 250 630 250 A | 25 | 20 | 6,3 | - |
| EGTP1 250 560 300 A | 30 | 25 | 5,6 | - |
| EGTP1 250 630 300 A | 30 | 25 | 6,3 | - |
| EGTP1 250 970 300 A | 30 | 25 | 9,7 | - |
| EGTP1 250 630 320 A | 32 | 27 | 6,3 | - |
| EGTP1 250 970 320 A | 32 | 27 | 9,7 | - |
| EGTP1 250 560 350 A | 35 | 30 | 5,6 | - |
| EGTP1 250 970 350 A | 35 | 30 | 9,7 | - |
| EGTP1 251 500 350 A | 35 | 30 | 15,0 | - |
| EGTP1 250 560 400 A | 40 | 35 | 5,6 | ISO 10766 |
| EGTP1 250 630 400 A | 40 | 35 | 6,3 | - |
| EGTP1 250 970 400 A | 40 | 35 | 9,7 | - |
| EGTP1 251 500 400 A | 40 | 35 | 15,0 | - |
| EGTP1 250 560 450 A | 45 | 40 | 5,6 | - |
| EGTP1 250 630 450 A | 45 | 40 | 6,3 | - |
| EGTP1 250 970 450 A | 45 | 40 | 9,7 | - |
| EGTP1 251 500 450 A | 45 | 40 | 15,0 | - |
| EGTP1 250 560 500 A | 50 | 45 | 5,6 | ISO 10766 |
| EGTP1 250 970 500 A | 50 | 45 | 9,7 | - |
| EGTP1 251 500 500 A | 50 | 45 | 15,0 | - |
| EGTP1 252 000 450 A | 45 | 40 | 20,0 | - |
| EGTP1 252 000 500 A | 50 | 45 | 20,0 | - |
| EGTP1 252 500 500 A | 50 | 45 | 25,0 | - |
| EGTP1 250 560 550 A | 55 | 50 | 5,6 | - |
| EGTP1 250 970 550 A | 55 | 50 | 9,7 | - |
| EGTP1 251 500 550 A | 55 | 50 | 15,0 | - |
| EGTP1 252 000 550 A | 55 | 50 | 20,0 | - |
| EGTP1 250 560 600 A | 60 | 55 | 5,6 | - |
| EGTP1 250 970 600 A | 60 | 55 | 9,7 | - |
| EGTP1 251 500 600 A | 60 | 55 | 15,0 | - |



Article

| Désignation | D (mm) | d (mm) | L (mm) | Rainures selon |
|---------------------|-----------|-----------|-----------|----------------|
| EGTP1 252 000 600 A | 60 | 55 | 20,0 | - |
| EGTP1 250 560 630 A | 63 | 58 | 5,6 | - |
| EGTP1 250 970 630 A | 63 | 58 | 9,7 | ISO 10766 |
| EGTP1 251 500 630 A | 63 | 58 | 15,0 | - |
| EGTP1 252 000 630 A | 63 | 58 | 20,0 | - |
| EGTP1 250 560 650 A | 65 | 60 | 5,6 | - |
| EGTP1 250 970 650 A | 65 | 60 | 9,7 | - |
| EGTP1 251 500 650 A | 65 | 60 | 15,0 | - |
| EGTP1 252 000 650 A | 65 | 60 | 20,0 | - |
| EGTP1 250 560 700 A | 70 | 65 | 5,6 | - |
| EGTP1 250 970 700 A | 70 | 65 | 9,7 | - |
| EGTP1 251 500 700 A | 70 | 65 | 15,0 | - |
| EGTP1 252 000 700 A | 70 | 65 | 20,0 | - |
| EGTP1 250 560 750 A | 75 | 70 | 5,6 | - |
| EGTP1 250 970 750 A | 75 | 70 | 9,7 | - |
| EGTP1 251 500 750 A | 75 | 70 | 15,0 | - |
| EGTP1 252 000 750 A | 75 | 70 | 20,0 | - |
| EGTP1 252 500 750 A | 75 | 70 | 25,0 | - |
| EGTP1 250 560 800 A | 80 | 75 | 5,6 | ISO 10766 |
| EGTP1 250 630 800 A | 80 | 75 | 6,3 | - |
| EGTP1 250 970 800 A | 80 | 75 | 9,7 | ISO 10766 |
| EGTP1 251 500 800 A | 80 | 75 | 15,0 | - |
| EGTP1 252 000 800 A | 80 | 75 | 20,0 | - |
| EGTP1 252 500 800 A | 80 | 75 | 25,0 | - |
| EGTP1 250 560 850 A | 85 | 80 | 5,6 | - |
| EGTP1 250 970 850 A | 85 | 80 | 9,7 | - |
| EGTP1 251 500 850 A | 85 | 80 | 15,0 | - |
| EGTP1 252 000 850 A | 85 | 80 | 20,0 | - |
| EGTP1 252 500 850 A | 85 | 80 | 25,0 | - |
| EGTP1 250 560 900 A | 90 | 85 | 5,6 | - |
| EGTP1 250 970 900 A | 90 | 85 | 9,7 | - |
| EGTP1 251 500 900 A | 90 | 85 | 15,0 | - |
| EGTP1 252 000 900 A | 90 | 85 | 20,0 | - |
| EGTP1 252 500 900 A | 90 | 85 | 25,0 | - |
| EGTP1 250 970 950 A | 95 | 90 | 9,7 | - |
| EGTP1 251 500 950 A | 95 | 90 | 15,0 | - |
| EGTP1 252 000 950 A | 95 | 90 | 20,0 | - |
| EGTP1 252 500 950 A | 95 | 90 | 25,0 | - |
| EGTP1 250 561 000 A | 100 | 95 | 5,6 | ISO 10766 |
| EGTP1 250 971 000 A | 100 | 95 | 9,7 | ISO 10766 |
| EGTP1 251 501 000 A | 100 | 95 | 15,0 | - |
| EGTP1 252 001 000 A | 100 | 95 | 20,0 | - |
| EGTP1 252 501 000 A | 100 | 95 | 25,0 | - |
| EGTP1 250 971 050 A | 105 | 100 | 9,7 | - |
| EGTP1 251 501 050 A | 105 | 100 | 15,0 | - |
| EGTP1 252 001 050 A | 105 | 100 | 20,0 | - |
| EGTP1 252 501 050 A | 105 | 100 | 25,0 | - |
| EGTP1 250 971 100 A | 110 | 105 | 9,7 | - |
| EGTP1 251 501 100 A | 110 | 105 | 15,0 | - |
| EGTP1 252 001 100 A | 110 | 105 | 20,0 | - |
| EGTP1 252 501 100 A | 110 | 105 | 25,0 | - |
| EGTP1 250 971 150 A | 115 | 110 | 9,7 | - |
| EGTP1 251 501 150 A | 115 | 110 | 15,0 | - |
| EGTP1 252 001 150 A | 115 | 110 | 20,0 | - |
| EGTP1 252 501 150 A | 115 | 110 | 25,0 | - |
| EGTP1 250 971 200 A | 120 | 115 | 9,7 | - |
| EGTP1 251 501 200 A | 120 | 115 | 15,0 | - |
| EGTP1 252 501 200 A | 120 | 115 | 25,0 | - |
| EGTP1 250 971 250 A | 125 | 120 | 9,7 | ISO 10766 |
| EGTP1 251 501 250 A | 125 | 120 | 15,0 | - |
| EGTP1 252 001 250 A | 125 | 120 | 20,0 | - |
| EGTP1 252 501 250 A | 125 | 120 | 25,0 | - |
| EGTP1 250 971 300 A | 130 | 125 | 9,7 | - |



Article

| Désignation | D (mm) | d (mm) | L (mm) | Rainures selon |
|---------------------|-----------|-----------|-----------|----------------|
| EGTP1 251 501 300 A | 130 | 125 | 15,0 | - |
| EGTP1 252 001 300 A | 130 | 125 | 20,0 | - |
| EGTP1 252 501 300 A | 130 | 125 | 25,0 | - |
| EGTP1 250 971 350 A | 135 | 130 | 9,7 | - |
| EGTP1 251 501 350 A | 135 | 130 | 15,0 | - |
| EGTP1 250 971 400 A | 140 | 135 | 9,7 | ISO 10766 |
| EGTP1 251 501 400 A | 140 | 135 | 15,0 | ISO 10766 |
| EGTP1 252 001 400 A | 140 | 135 | 20,0 | - |
| EGTP1 252 501 400 A | 140 | 135 | 25,0 | - |
| EGTP1 251 501 450 A | 145 | 140 | 15,0 | - |
| EGTP1 252 001 450 A | 145 | 140 | 20,0 | - |
| EGTP1 252 501 450 A | 145 | 140 | 25,0 | - |
| EGTP1 250 971 500 A | 150 | 145 | 9,7 | - |
| EGTP1 251 501 500 A | 150 | 145 | 15,0 | - |
| EGTP1 252 001 500 A | 150 | 145 | 20,0 | - |
| EGTP1 252 501 500 A | 150 | 145 | 25,0 | - |
| EGTP1 250 971 600 A | 160 | 155 | 9,7 | ISO 10766 |
| EGTP1 251 501 600 A | 160 | 155 | 15,0 | ISO 10766 |
| EGTP1 252 001 600 A | 160 | 155 | 20,0 | - |
| EGTP1 252 501 600 A | 160 | 155 | 25,0 | - |
| EGTP1 252 501 650 A | 165 | 160 | 25,0 | - |
| EGTP1 250 971 700 A | 170 | 165 | 9,7 | - |
| EGTP1 251 501 700 A | 170 | 165 | 15,0 | - |
| EGTP1 252 501 700 A | 170 | 165 | 25,0 | - |
| EGTP1 250 971 800 A | 180 | 175 | 9,7 | ISO 10766 |
| EGTP1 251 501 800 A | 180 | 175 | 15,0 | ISO 10766 |
| EGTP1 252 501 800 A | 180 | 175 | 25,0 | - |
| EGTP1 251 501 850 A | 185 | 180 | 15,0 | - |
| EGTP1 250 971 900 A | 190 | 185 | 9,7 | - |
| EGTP1 250 972 000 A | 200 | 195 | 9,7 | ISO 10766 |
| EGTP1 251 502 000 A | 200 | 195 | 15,0 | - |
| EGTP1 252 002 000 A | 200 | 195 | 20,0 | - |
| EGTP1 252 502 000 A | 200 | 195 | 25,0 | - |
| EGTP1 252 502 050 A | 205 | 200 | 25,0 | - |
| EGTP1 251 502 200 A | 220 | 215 | 15,0 | ISO 10766 |
| EGTP1 252 502 250 A | 225 | 220 | 25,0 | - |
| EGTP1 252 502 300 A | 230 | 225 | 25,0 | - |
| EGTP1 252 502 400 A | 240 | 235 | 25,0 | - |
| EGTP1 251 502 450 A | 245 | 240 | 15,0 | - |
| EGTP1 251 502 500 A | 250 | 245 | 15,0 | ISO 10766 |
| EGTP1 252 502 500 A | 250 | 245 | 25,0 | - |
| EGTP1 252 503 000 A | 300 | 294 | 25,0 | - |
| EGTP1 252 503 600 A | 360 | 355 | 25,0 | - |