

K-DRUCKSCHALTER VAKUUM

Combined vacuum/pressure switch

HANSA FLEX

Caractéristiques

Construction	PNP
Raccord de fluide de mesure	G 1/8 male and M 5 female
Hystérésis	Adjustable: 3 to 25% of set value
Plage de température	0 - 50 °C
Médiums	Non-aggressive gases, dry, oil-free air
Boîtier	Polycarbonate
Signal de sortie	Analogue: 1 to 5 V
Raccord électrique	Male connector M8, four pin
Capacité de commutation	125 mA
Consommation d'électricité	30 mA
Affichage d'état	LED

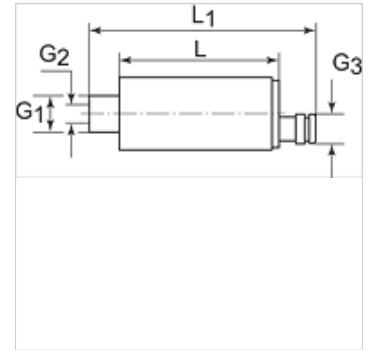
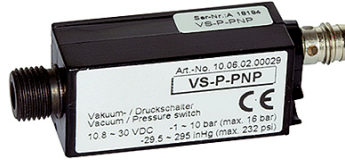

Remarque

Autres informations sur demande.

Description

Universal electronic vacuum and pressure switch for safety monitoring, optimisation of cycle times and regulation circuits. Its small size and low weight permit installation directly at the point of use. Suitable for all special applications in the vacuum and compressed air sectors. Adjustable vacuum limit value and continuous vacuum monitoring.

Article

Désignation	G1 extérieur	G2 intérieur	G3 extérieur	L (mm)	L1 (mm)	Plage de mesure	Tension
K- 07 45 01 31	G 1/8	M 5	M 8 x 1	44,0	62,0	-1 bis +10 bar	10.8 - 30 V DC