

K-3/2-BKR MULTIFIX MINI

Ball valves

HANSA FLEX

Caractéristiques

Température de fluide	max. 60 °C
Température ambiante	Max. 60 °C
Actionnement	Twist knob, rotatable 90°
Débit	1800 l/min
Raccord de ventilation	Silencer G 1/4
Matériau étanche	NBR
Boîtier	Die-cast zinc
Mesure de la valeur du débit	At P1 = 6 bar and pressure drop $\Delta p = 1$ bar

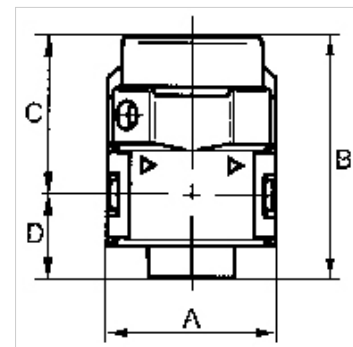
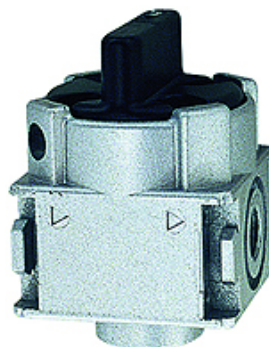

Remarque

If several devices in the »multifix-mini« Series are assembled together, the maximum working pressure is 12 bar.

Autres informations sur demande.

Description

Rotary switch can be turned 90°, lockable, with relief port

Article

Désignation	Filets	A (mm)	B	C (mm)	D (mm)	Gabarit
K- 07 25 11 56	G 1/8	40,0	57,6 mm	37,6	20,0	0
K- 07 25 11 57	G 1/4	40,0	57,6 mm	37,6	20,0	0

Pièces de rechange

K-KOPPELPAKET MEHR	Coupling packet
K-AUTOMAT ABLASSVENTIL	Automatic drain valve
K-SCHALLDAE SINTERBR SCHLITZ	Silencers, sintered bronze, slotted