

K-VT MULTIFIX MINI

Manifold

HANSA FLEX

Caractéristiques

Pression d'entrée	Max. 16 bar
Température de fluide	max. 60 °C
Température ambiante	Max. 60 °C
Débit	P-A = 2700 l/min\nP-B and P-C = 1300 l/min
Matériau étanche	NBR
Boîtier	Die-cast zinc
Mesure de la valeur du débit	At P1 = 6 bar and pressure drop $\Delta p = 1$ bar

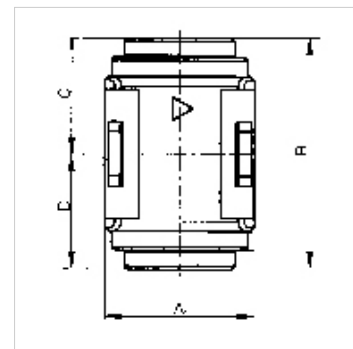
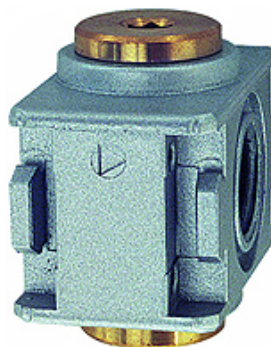

Remarque

If several devices in the »multifix-mini« Series are assembled together, the maximum working pressure is 12 bar.

Autres informations sur demande.

Description

Narrow, two-way manifold with two G 1/8 outlets.

Article

Désignation	Filets	A (mm)	B	C (mm)	D (mm)
K- 07 25 11 81	G 1/4	23,0	36,0 mm	18,0	18,0

Pièces de rechange

K-KOPPELPAKET MEHR Coupling packet