

# K-SAUGKOERBE FUER RUECKSCHLAGV

Strainers for check valves

**HANSA FLEX**

## Caractéristiques

Description filetage Stainless steel 1.4301

Plage de température max. +150 °C

Matériau étanche NBR

Boîtier, tissu filtrant Stainless steel 1.4301

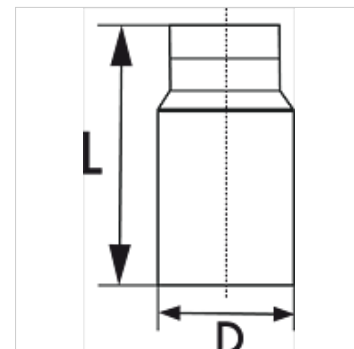
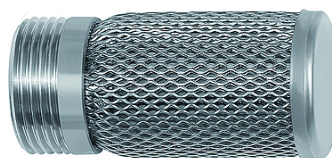

## Description

Corrosion resistant screw-in strainer, all stainless steel, to suit foot-operated or check valves.

## Article

Désignation	Filets	D (mm)	L (mm)	Maillage (mm)
K- 07 30 30 52	G 3/8	19,0	55,0	1,0
K- 07 30 30 47	G 1/2	22,0	55,0	1,0
K- 07 30 30 51	G 3/4	29,0	62,0	1,0
K- 07 30 30 44	G 1	36,0	71,0	1,0
K- 07 30 30 46	G 1 1/4	43,0	80,0	1,0
K- 07 30 30 45	G 1 1/2	49,0	90,0	1,0
K- 07 30 30 48	G 2	60,0	101,0	1,0
K- 07 30 30 49	G 2 1/2	80,0	111,0	1,8
K- 07 30 30 50	G 3	92,0	125,0	1,8