

K-MV G (NC) D 24 V DC STA

Normally closed, (NC), directly operated, 24 V DC, standard type

HANSA FLEX

Caractéristiques

| | |
|---------------------------------|---|
| Raccord électrique | device socket type A in acc. with ISO 4400 for all valves with threads G 3/8 & G 1/2, except valves type 3 & 4. Device socket |
| Description filetage | G thread acc. DIN EN ISO 228-1 |
| Température de fluide | max. 80 °C when using water or oils; max. 90 °C when using with air |
| Indice de protection | IP 65 |
| Pression de service maxi | 10 bar |
| Matériau étanche | FPM |
| Boîtier, siège de vanne | Stainless steel 1.4301 |
| Pièces internes | Stainless steel |

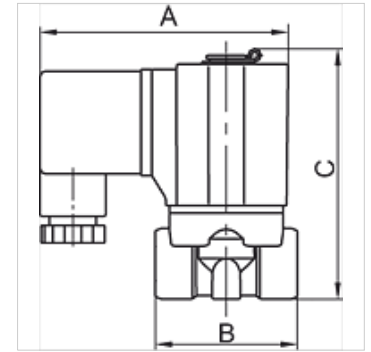

Remarque

Autres informations sur demande.

Description

Standard series in two different versions: Directly operated, Pilot-operated

Article

| Désignation | Filets | VN | A (mm) | B (mm) | C (mm) | Conception |
|----------------|--------|-----|-----------|-----------|-----------|------------|
| K- 07 30 01 20 | G 1/8 | 3,0 | 70,0 | 40,0 | 70,7 | 1 |
| K- 07 30 01 21 | G 1/4 | 3,0 | 70,0 | 40,0 | 70,7 | 1 |
| K- 07 30 01 22 | G 3/8 | 5,0 | 85,0 | 52,0 | 87,0 | 1 |
| K- 07 30 01 23 | G 1/2 | 5,0 | 85,0 | 52,0 | 87,0 | 1 |