

K-MV G (NC) D 230 V, 50 HZ STA 1

Normally closed, (NC), directly operated, 230 V, 50 Hz, standard type

HANSA FLEX

Caractéristiques

Raccord électrique	device socket type A in acc. with ISO 4400 for all valves with threads G 3/8 & G 1/2, except valves type 3 & 4. Device socket
Description filetage	G thread acc. DIN EN ISO 228-1
Température de fluide	max. 80 °C when using water or oils; max. 90 °C when using with air
Indice de protection	IP 65
Pression de service maxi	10 bar
Matériau étanche	FKM
Boîtier, siège de vanne	Stainless steel 1.4301
Pièces internes	Stainless steel
Matériau	sealing: FKM (FPM)

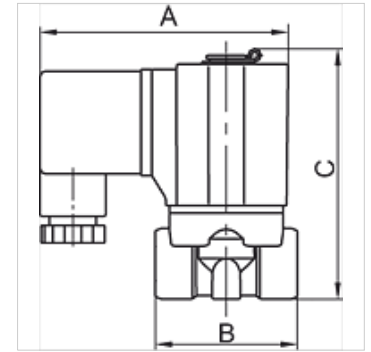

Remarque

Autres informations sur demande.

Description

Standard series in two different versions: Directly operated, Pilot-operated

Article

Désignation	Filets	VN	A (mm)	B (mm)	C (mm)	Conception
K- 07 30 01 12	G 1/8	3,0	70,0	40,0	70,7	1
K- 07 30 01 13	G 1/4	3,0	70,0	40,0	70,7	1
K- 07 30 01 14	G 3/8	5,0	85,0	52,0	87,0	1
K- 07 30 01 15	G 1/2	5,0	85,0	52,0	87,0	1