

K-W TUE VB PP

Union elbows

HANSA FLEX

Caractéristiques

Pression de service	on request
Température de service	Max. +20 °C
Matériau	Polypropylène (PP)
Matériau étanche	NBR

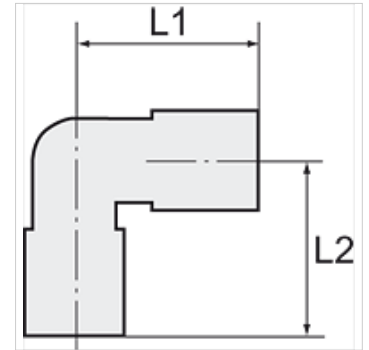

Remarque

Autres informations sur demande.

Description

Lightweight, push-in fittings distinguished by high strength, toughness, resistance to abrasion and impact resistance - ideal for a wide range of applications. Plastic and metal tubes are connected together quickly and easily. Suitable for compressed air or liquids, with good resistance to a large number of chemicals.

Article

Désignation	pour Ø ext. du tuyau	L1 (mm)	L2 (mm)	Manchons (mm)
K- 07 40 29 10	32 mm	105,3	96,0	32