

K-L-STECKVER DREH AG OR VA

Male elbows, swivel type, parallel male thread with O-ring



Caractéristiques

Pression de service par impulsions	Max. 10 bar
Pression	Max. 15 bar (depending on pipe quality)
Matière première appropriée	PVDF, PTFE, stainless steel, PA, PU
Norme	G thread acc. to DIN EN ISO 228-1, with O-Ring
Température ambiante	-20 °C to max. +150 °C (depending on pipe quality and diameter)
Matériau	Acier inoxydable 1.4404
Matériau étanche	FKM

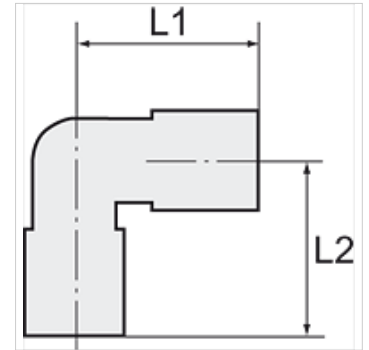
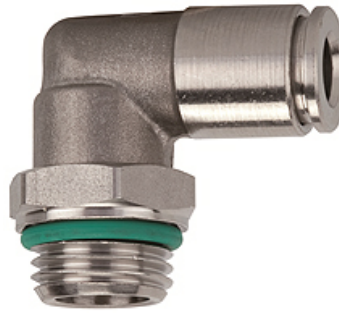

Remarque

Autres informations sur demande.

Description

For use with aggressive media and in areas with corrosive outside influences, in the food processing industry and in hygienic and sanitary applications.

Article

Désignation	Filets	pour Ø ext. du tuyau	L1 (mm)	L2 (mm)	SW
K- 07 40 46 76	M 5	4 mm	17,0	14,0	9 mm
K- 07 40 23 91	G 1/8	4 mm	17,0	16,0	13 mm
K- 07 40 23 93	G 1/8	8 mm	22,0	18,0	13 mm
K- 07 40 23 92	G 1/8	6 mm	21,5	18,0	13 mm
K- 07 40 23 89	G 1/4	6 mm	21,5	20,0	16 mm
K- 07 40 23 90	G 1/4	8 mm	22,0	20,0	16 mm
K- 07 40 23 88	G 1/4	10 mm	25,5	22,5	16 mm
K- 07 40 23 94	G 3/8	10 mm	25,5	24,0	21 mm
K- 07 40 23 95	G 3/8	12 mm	28,0	26,5	21 mm
K- 07 40 23 87	G 1/2	12 mm	28,0	31,0	22 mm