

# K-DRV AG-K STECK SCHL GEW

Unidirectional flow control valves with parallel male thread and plug connection, straight type, air restriction from tube to port

**HANSA FLEX**

## Caractéristiques

|                       |  |
|-----------------------|--|
| Pression de service   | Max. 15 bar, coarse vacuum   |
| Domaine d'utilisation | Air, vacuum  |
| Tuyaux recommandés    | PU or PA (nylon)   |
| Médiums               | Compressed air and all gases or liquids that are compatible with the materials |
| Plage de température  | -20 °C to +80 °C   |
| Surface d'étanchéité  | Parallel version: O-ring in housing, Conical version: thread coating           |
| Matériau              | Plastic, Nickel plated brass   |
| Bague de pression     | Plastic  |

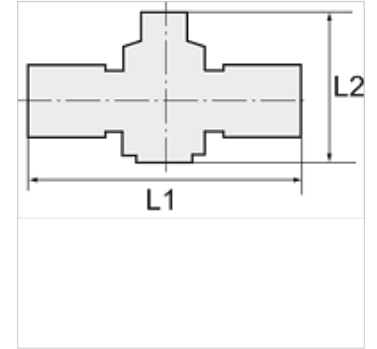

## Remarque

Autres informations sur demande.

## Description

Push-in fittings series manufactured in plastic and nickel-plated brass. All parts are suitable for use with hoses, tubes or pipes made of plastic and copper.

## Article

| Désignation    | Filets | pour Ø ext. du tuyau | L1 (mm) | L2 mini (mm) | L2 maxi (mm) | SW    |
|----------------|--------|----------------------|---------|--------------|--------------|-------|
| K- 07 40 06 99 | G 1/8  | 4 mm                 | 46,5    | 28,9         | 31,2         | 12 mm |
| K- 07 40 07 00 | G 1/8  | 6 mm                 | 53,7    | 41,1         | 46,8         | 14 mm |
| K- 07 40 07 01 | G 1/8  | 8 mm                 | 58,1    | 41,7         | 47,4         | 14 mm |
| K- 07 40 06 97 | G 1/4  | 6 mm                 | 55,1    | 40,8         | 47,0         | 14 mm |
| K- 07 40 06 98 | G 1/4  | 8 mm                 | 59,6    | 44,8         | 50,8         | 17 mm |
| K- 07 40 06 95 | G 1/4  | 10 mm                | 70,3    | 47,4         | 54,0         | 17 mm |
| K- 07 40 06 96 | G 1/4  | 12 mm                | 80,6    | 50,3         | 55,3         | 21 mm |
| K- 07 40 07 04 | G 3/8  | 8 mm                 | 61,0    | 44,3         | 50,4         | 17 mm |
| K- 07 40 07 02 | G 3/8  | 10 mm                | 71,6    | 48,5         | 55,3         | 20 mm |
| K- 07 40 07 03 | G 3/8  | 12 mm                | 81,3    | 51,8         | 57,1         | 21 mm |
| K- 07 40 06 93 | G 1/2  | 10 mm                | 76,0    | 48,3         | 54,5         | 19 mm |
| K- 07 40 06 94 | G 1/2  | 12 mm                | 85,9    | 51,5         | 56,8         | 24 mm |