

K-W90 VERSCHR POLYPROPYLEN

Union elbows - polypropylene

HANSA FLEX

Caractéristiques

Pression de service	Dependent on operating temperature; Max. 10 bar (at 20 °C); Max. 2.5 bar (at 90 °C)
Matériau	Polypropylene (PP)
Température de service	Max. 90 °C

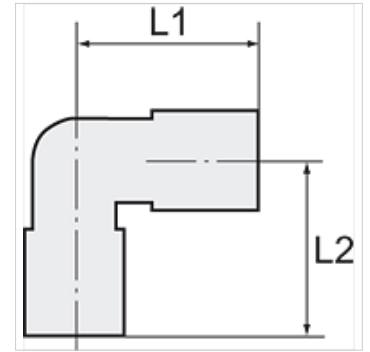

Remarque

Autres informations sur demande.

Description

Chemically resistant to almost all inorganic acids and bases, even in high concentrations and at temperatures greater than 90 °C.

Article

Désignation	pour tuyau	Filets	L1 (mm)	L2 (mm)
K- 07 40 41 79	4 mm / 6 mm	G 1/8	25,0	20,0
K- 07 40 41 81	6 mm / 8 mm	G 1/8	30,0	23,0
K- 07 40 41 83	8 mm / 10 mm	G 1/8	36,0	25,0
K- 07 40 41 85	9 mm / 12 mm	G 1/8	40,0	27,0
K- 07 40 41 86	4 mm / 6 mm	G 1/4	26,0	25,0
K- 07 40 41 88	6 mm / 8 mm	G 1/4	30,0	27,0
K- 07 40 41 90	8 mm / 10 mm	G 1/4	36,0	32,0
K- 07 40 41 92	9 mm / 12 mm	G 1/4	40,0	31,0
K- 07 40 41 93	4 mm / 6 mm	G 3/8	29,0	30,0
K- 07 40 41 95	6 mm / 8 mm	G 3/8	33,0	27,0
K- 07 40 41 97	8 mm / 10 mm	G 3/8	36,0	29,0
K- 07 40 41 99	9 mm / 12 mm	G 3/8	40,0	31,0
K- 07 40 42 00	4 mm / 6 mm	G 1/2	32,0	29,0
K- 07 40 42 02	6 mm / 8 mm	G 1/2	36,0	29,0
K- 07 40 42 04	8 mm / 10 mm	G 1/2	39,0	31,0
K- 07 40 42 06	9 mm / 12 mm	G 1/2	43,0	33,0