

Karakteristike

Priključak 1	metrički navoji matice
Oblik brtve 1	24° vanjski konus s O prstenom
Priključak 2 + 3	metrički vanjski navoji, cilindrični
Oblik brtve 2 + 3	24° unutarnji konus
Izvedba	Vijčani spojevi, podesivi po smjeru
Oblik izrade	T oblik
Norma	ISO 8434-1
Opseg isporuke	Nastavak (bez pretorne matice i nareznog prstena)
Materijal	Čelik
Površinska zaštita	galvanski premaz

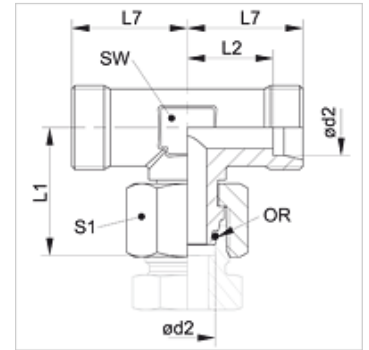

Napomena

Upute za montažu, ugradnju, tlačno opterećenje i dopuštene radne temperature pronaći ćete u tehničkim informacijama za vijčane spojeve cijevi.

Artikli

Naziv	Seriya	Radni tlak bari	Ø d2 (mm)	L1 (mm)	L2 (mm)	L7 (mm)	SW (mm)	S1	OR
XVETO NW 04 HL	L	PN 315	6	26,0	12,0	19	12	14	4,0 x 1,5
XVETO NW 06 HL	L	PN 315	8	26,5	14,0	21	12	17	6,0 x 1,5
XVETO NW 08 HL	L	PN 315	10	29,0	15,0	22	14	19	7,5 x 1,5
XVETO NW 10 HL	L	PN 315	12	29,5	17,0	24	17	22	9,0 x 1,5
XVETO NW 13 HL	L	PN 315	15	33,0	21,0	28	19	27	12,0 x 2,0
XVETO NW 16 HL	L	PN 315	18	35,5	23,5	31	24	32	15,0 x 2,0
XVETO NW 20 HL	L	PN 160	22	39,5	27,5	35	27	36	20,0 x 2,0
XVETO NW 25 HL	L	PN 160	28	43,0	30,5	38	36	41	26,0 x 2,0
XVETO NW 32 HL	L	PN 160	35	51,0	34,5	45	41	50	32,0 x 2,5
XVETO NW 40 HL	L	PN 160	42	56,0	40,0	51	50	60	38,0 x 2,5
XVETO NW 03 HS	S	PN 630	6	27,0	16,0	23	12	17	4,0 x 1,5
XVETO NW 04 HS	S	PN 630	8	27,5	17,0	24	14	19	6,0 x 1,5
XVETO NW 06 HS	S	PN 630	10	30,0	17,5	25	17	22	7,5 x 1,5
XVETO NW 08 HS	S	PN 630	12	31,5	21,5	29	17	24	9,0 x 1,5
XVETO NW 10 HS	S	PN 630	14	35,0	22,0	30	19	27	10,0 x 2,0
XVETO NW 13 HS	S	PN 400	16	37,5	24,5	33	24	30	12,0 x 2,0
XVETO NW 16 HS	S	PN 400	20	45,0	26,5	37	27	36	16,3 x 2,4
XVETO NW 20 HS	S	PN 400	25	50,5	30,0	42	36	46	
XVETO NW 25 HS	S	PN 400	30	55,0	35,5	49	41	50	25,3 x 2,4
XVETO NW 32 HS	S	PN 315	38	63,0	41,0	57	50	60	33,3 x 2,4

Seriya: LL = veoma lagan L = lagan S = težak - PN = nazivni tlak PB = maks. radni tlak - Ø d2 = vanjski promjer cijevi

Varijante proizvoda

XVETO VA	Vijčani spoj, T oblik, Oplemenjeni čelik
VETO	Vijčani spoj, T oblik, Čelik